

INSTRUCTION MANUAL

HIGH PRESSURE WASHER



- **Empty air before use**
- **Do not suggest self priming**

This appliance is not intended for use by persons (including children) with reduced physical, sensory or capabilities, or lack of experience and knowledge, unless they have been given supervision or instruction concerning use of the appliance by a person responsible for their safety. Children should be supervised to ensure that they do not play with the appliance.

The function of Safety valve: when the pressure of the pump exceeds the Preset valve, returns the excess fluid to the inlet system.

The function of pressure switch: When turn off a gun, pressure switch on the action, cut off the power supply for protection operations.

PRECAUTIONS:

1. Assemble the pressure washer correctly according to the instructions;
2. To avoid mishandling of device, do not bend the water inlet pipe after opening the water valve.
3. Connect the power cord plug into the socket, making sure the leakage protection indicator is on;
4. Remove the nozzle on the spray gun and then turn on the switch of the washer and the spray lance. Ensure that the end of the spray gun continues to discharge water for 5 seconds.
5. After turning off the switch and reinstalling the nozzle, the pressure washer is ready for use.
6. Our electric power washer features a safety automatic total stop system (TSS), which automatically shuts off the pump when the trigger is not engaged.

WARM TIPS FOR STORAGE PURPOSES

1. Turn off the water source and the power source, then open the spray lance to release the internal pressure after every use;
2. In order to prevent the water from freezing, please empty the water inside the washer and store it indoors during winter;

		1/2"). Clean the nozzle. Clean the filter. Straighten out hose.
Machine often starts and stops by itself.	Pump/spray gun is leaking.	Contact your nearest Service.
Machine starts, but no water comes out.	Pump/hoses or accessory frozen. No Water supply. Water filter blocked Nozzle blocked	Wait for pump/hoses or accessory to thaw. Connect water supply and turn on. Clean the filter. Clean the nozzle.

TROUBLESHOOTING

Disconnect the machine from the power source before making any repair. To avoid unnecessary disappointments, you should check the following before contacting the service organization:

Symptom	Cause	Recommended action
Machine refuses to start.	Machine not plugged in Defective socket. Defective extension cable.	Plug in machine. Try another socket. Try without the extension cable.
Fluctuating pressure.	Pump sucking air. Valves dirty, worn out or stuck. Pump seals worn out.	Check that hoses and connections are airtight. Clean and replace or refer to local distributor. Clean and replace or refer to local distributor.
Machine stops	Incorrect mains voltage. Thermal cut-out activated. Nozzle partially blocked.	Check that the mains voltage corresponds to specification on the model tag. Leave the washer for 5 minutes to cool down. Clean the nozzle.
Machine pulsating	Air in inlet hose. Inadequate supply of mains water. Nozzle partially blocked. Water filter blocked. Hose kinked.	Pump allow machine to run with open trigger until regular working pressure resumes. Check that the water supply corresponds to specifications required. Avoid using long, thin hoses (min.

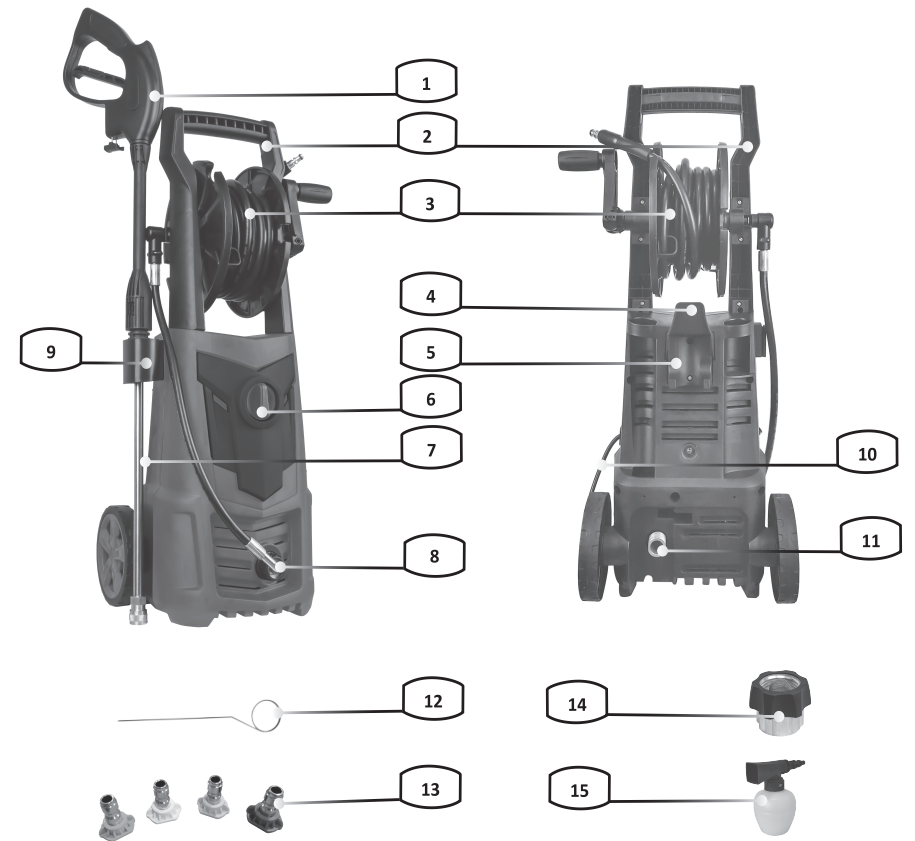

Component list

- | | |
|-------------------------------|--|
| 1. Spray gun | 9. Gun hook |
| 2. Handle | 10. Cable |
| 3. Hose reel | 11. Inlet with protection cap |
| 4. Cable hook | 12. Cleaning needle |
| 5. Soap hook | 13. 4 Nozzles |
| 6. Switch | 14. Inlet filter (attached on the machine) |
| 7. Spray lance | 15. Soap bottle |
| 8. Outlet with protection cap | |

ASSEMBLY

1. ASSEMBLING GUN HOOK

Press the gun hook (4) to the machine. (See Fig A)

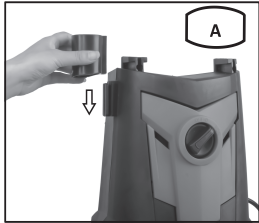

2. MOUNTING OF HANDLE

Press the hose reel (2) to the machine, and fix the two screws. (See Fig B , C)

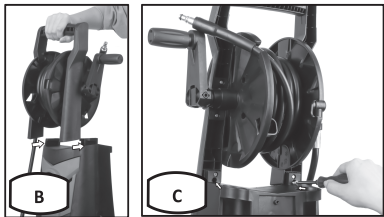

3. ASSEMBLING CABLE HOOK

Press the cable hook (4) to the machine, and fix the two screws. (See Fig D , E)

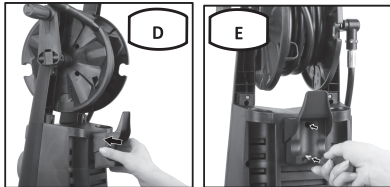

4. MOUNTING OF INLET WATER FILTER

- 1) Remove the protection cap(a) of inlet firstly. (See Fig F)
- 2) Attach the inlet filter(14) to the machine's inlet. (See Fig G)

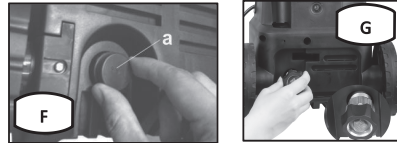

5. ASSEMBLING HIGH PRESSURE HOSE

- 1) Insert the adjustable spray lance (7) into spray gun (1), and twist 1/4 turn until rectangular tab appears. Then insert the nozzle(13). (See Fig H)
- 2) Make sure that ON/OFF switch is in OFF position. (See Fig I)
- 3) Tighten the high pressure hose into spray gun (1). But do not over tighten. (See Fig J)
- 4) Remove the protection cap (b) of outlet firstly, then connection the pressure hose to the machine's outlet (8), make sure it is connected firmly. (See Fig K,L,M)

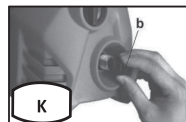
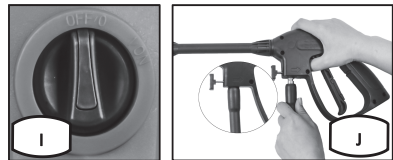
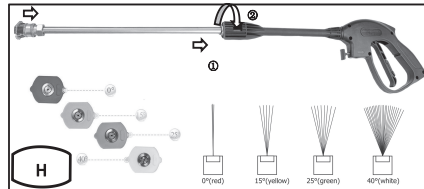

TECHNICAL DATA

Voltage:	120V/60Hz
Wattage:	1500W
Degree of protection:	IPX5
Rated temperature:	0-40°C
Insulation class:	□/II
N.W.:	7.2kg

Note: Operating water pressure and maximum water pressure are obtained in the experimental test environment, which may be different from the actual use environment.

OPREATING

INSTRUCTIONS



NOTE: Before using the tool ,read the instruction book carefully.



CAUTION:

- Never use the pressure washer to draw in water contaminated with solvents (e.g. paint thinners, gasoline, oil, etc.).
- Dirt in the feed water will damage the unit. To avoid this risk, we recommended checking the water filter (located inside the water inlet; to clean it out see maintenance section).
- Always prevent debris from being drawn into the unit by using a clean water source and an accessory water source and an accessory water filter if required.

Water supply (cold-water only)

1. Do not draw non-water liquids through the unit. For use with cold water supply only.
2. Water hose must be at least a 1/2" in diameter.
3. Flow rate can be determined by running the water for one minute into an empty container.
4. The water supply temperature must not exceed 40°C (104°F)

- ◆ **WARNING:** Risk of explosion - Do not spray flammable liquids.
- ◆ **WARNING:** To ensure machine safety, use only original spare parts from the manufacturer or approved by the manufacturer.
- ◆ **WARNING:** High pressure hoses, fittings and couplings are important for the safety of the appliance. Use only hoses, fittings and couplings recommended by the manufacturer.
- ◆ **WARNING:** Water that has flown through backflow preventers is considered to be non-potable.
- ◆ **WARNING:** The machine shall be disconnected from its power source by removing the plug from the socket-outlet during leaning or maintenance and when replacing parts or converting the machine to another function.
- ◆ **WARNING:** Do not use machine if a supply cord or important parts of the machine are damaged, e.g. safety devices, high pressure hoses, trigger gun.
- ◆ **WARNING:** If an extension cord is used, the plug and socket must be of watertight construction.
- ◆ **WARNING:** Inadequate extension cords can be dangerous.
- ◆ The electric supply connection shall be made by a qualified electrician and comply with IEC 60364-1. It is recommended that the electric supply to this machine should include either a residual current device that will interrupt the supply if the leakage current to earth exceeds 30 mA for 30 ms or a device that will prove the earth circuit.

SYMBOLS



Warning: Do not direct the jet at persons, animals and electrical equipment.



Read the manual



Machine not suitable for connection to the potable water mains



Double insulation



RCM approval mark

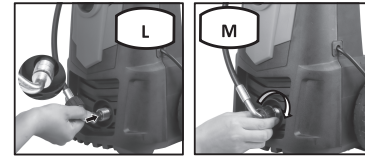

OPERATION

1. ON/OFF SAFETY SWITCH

- 1) Connect the plug into a properly out.
- 2) Trigger switch is in a locked off position to prevent in accidental starting. Depress safety lock (d) to "unlocking" position, then trigger switch is now on. (See Fig. N)
- 3) Start the pressure washer by turning ON/OFF switch to ON Press the trigger.(See Fig. O) Reminder: motor does not run continuously, only when trigger is squeezed.
- 4) Before operating the high pressure washer, press the trigger switch to bleed any trapped air out of the pump and hose. (See Fig. P)

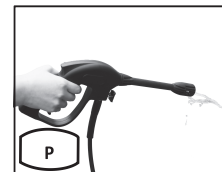
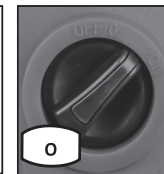
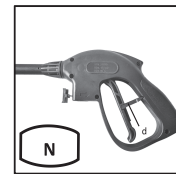

2. SURFACE PREPARATION

Before starting any cleaning task it is important the area for objects which could create a hazard. Remove objects from the work area which could be tripped over, such as toys or outdoor furniture. Ensure that all doors and windows are closed tight.

3. SURFACE PREPARATION

1) Adjusting the spray

The adjustable spray lance allows you to use any variety of spray patterns from a fan spray to a pencil jet spray. When using pressure washer to clean wood decks, siding, vehicles etc., always start using the fan spray and begin spraying from a minimum 36" away to avoid damaging the surface of the material you are cleaning. (See Fig. Q)



CAUTION: Do not adjust the nozzle while the trigger is squeezed.

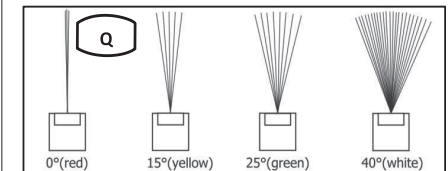

NOTE: The four nozzles have different shapes of water, as shown in the figure above.



CAUTION: Jet spray adjustment is very aggressive. Do not adjust while spraying. We recommend that for most cleaning applications a 20-degree spray angle should be used to avoid damage to the surface being sprayed.

2) Using the soap bottle

Insert the adjustable the soap bottle (15) into spray gun (1), and twist 1/4 turn until rectangular tab appears. (See Fig. R)



NOTE:Detergent need to be diluted to achieve the most effective cleaning. it is recommended to dilute the dletergent in suitable containerto therequired concentration before using.

WARNING:

1. After use, you need to turn off the water, turn off the gun, remove the barrel, and then fire the gun to remove the internal pressure of the product to prevent the product overflow valve from being under pressure for a long time;
2. Especially in winter weather, the product needs to be drained and placed indoors to avoid freezing of the water inside the product.

ACCESSORIES

Spray gun	1
Spray lance	1
4 Nozzles	1
Gun hook	1
Cleaning needle	1
6m High pressure hose	1
Cable hook	1
Water filter(fitted within inlet)	1
250ml Soap bottle	1

Use good quality accessories marked with a well-known brand name. Choose the type according to the work you intend to undertake. Refer to the accessory packaging for further details. Store personnel can assist you and offer advice.

GENERAL POWER

TOOL SAFETY

WARNINGS

 **WARNING:** Read all safety warnings and all instructions. Failure to follow the warnings and instructions may result in electric shock , fire and/or serious injury.

Save all warnings and instructions for future reference.

- This appliance is not intended for use by persons (including children) with reduced physical, sensory or mental capabilities, or lack of experience and knowledge, unless they have been given supervision or instruction concerning use of the appliance by a person responsible for their safety.
 - Children should be supervised to ensure that they do not play with the appliance.
 - If the supply cord is damaged, it must be replaced by the manufacturer, its service agent or similarly qualified persons in order to avoid a hazard.
-

ADDITIONAL

POWER TOOL

SAFETY

WARNINGS

 **WARNING:** Do not use the appliance without reading the instruction sheet.

- ◆ Safety boots, safety gloves, safety helmets with visors, hearing protection etc. shall be worn while operating the machine.
- ◆ When opening the trigger gun, there is a danger of the kickback force and the sudden torque on the spray assembly. Please hold the nozzles tightly.
- ◆ **WARNING:** This machine has been designed for use with the cleaning agent supplied or recommended by the manufacturer. The use of other cleaning agents or chemicals may adversely affect the safety of the machine.
- ◆ **WARNING:** High pressure jets can be dangerous if subject to misuse. The jet must not be directed at persons, live electrical equipment or the machine itself.
- ◆ **WARNING:** Do not use the machine within range of persons unless they wear protective clothing.
- ◆ **WARNING:** Do not direct the jet against yourself or others in order to clean clothes or foot-wear.
- ◆ Disconnect from the electrical power supply before carrying out user maintenance.
- ◆ High pressure cleaner should not be taken by children or untrained persons.