

# **VEVOR<sup>®</sup>**

**TOUGH TOOLS, HALF PRICE**

Support and E-Warranty Certificate  
<https://www.vevor.com/support>

## **HEAT PRESS MACHINE F380 USER MANUAL**

We continue to be committed to providing you tools at competitive prices. "Save Half", "Half Price" or any other similar expressions used by us only represent an estimate of savings you might benefit from buying certain tools with us compared to the major top brands and do not necessarily mean to cover all categories of tools offered by us. You are kindly reminded to verify carefully when placing an order with us if you are saving half in comparison with the top major brands.



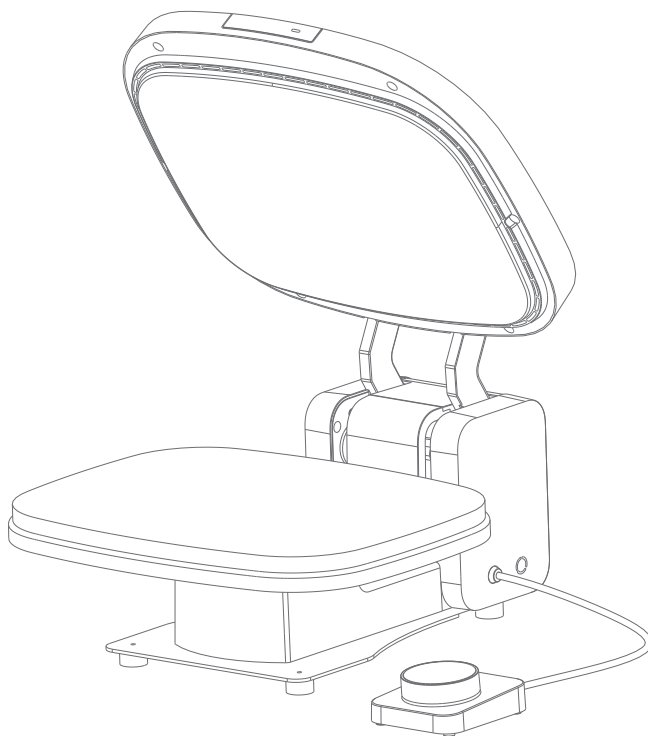

### NEED HELP? CONTACT US!

Have product questions? Need technical support? Please feel free to contact us:

**[CustomerService@vevor.com](mailto:CustomerService@vevor.com)**

This is the original instruction, please read all manual instructions carefully before operating. VEVOR reserves clear interpretation of our user manual. The appearance of the product shall be subject to the product you received. Please forgive us that we won't inform you again if there is any technology or software updates on our product.

# SAFETY INSTRUCTION

When using electrical appliances, basic safety precautions should always be followed including the following :



Warning

To reduce the risk of injury, the user must read the instructions manual carefully and save this instruction.

## Description of the symbols

	This symbol, placed before a safety comment, indicates a kind of precaution, warning, or danger. Ignoring this warning may lead to an accident. Please always follow the recommendation below to reduce the risk of injury, fire, or electrocution.
	This product is subject to the provision of European Directive 2012/19/EC. The symbol showing a wheeled bin crossed through indicates that the product requires separate refuse collection in the European Union. This applies to the product and all accessories marked with this symbol. Products marked as such may not be discarded with normal domestic waste, but must be taken to a collection point for recycling electrical and electronic devices.
	This device complies with Part 15 of the FCC Rules. Operation is subject to the following two conditions: (1) This device may not cause harmful interference, and (2) this device must accept any interference received, including interference that may cause undesired operation.

## WARNING

1. Warnings must be followed carefully to avoid body injury. improper use may result in electric shock, fire, personal injury, and other damage:
  - 1) Keep unplugged when moving the machine.
  - 2) keep unplugged when installing accessories.
  - 3) Place on a flat and stable platform and operate under ventilated conditions.
  - 4) Wear special protective equipment when operating the machine.
  - 5) Do not use this machine in a hazardous location.
  - 6) Only use it when the machine is working correctly.
  - 7) Do not disassemble and repair this machine.
  - 8) Do not use an unsuitable AC outlet.
  - 9) Do not touch the heating plate when the machine heating
  - 10) Do not use in humid environments or in contact with water. Also, do not infiltrate liquid in the machine to prevent fire or electric shock caused by a short circuit.
  - 11) Do not use the power supply that does not meet the rated voltage. The power supply that does not meet the specified voltage may cause fire or electric shock.
  - 12) Ensure that the machine is grounded so as not to cause harm to body.
  - 13) Do not touch the rotating rod or bearing part with your fingers during use in case of injuries.
  - 14) If the machine is not in use for a long time, please unplug the power cord from the socket.
  - 15) Do not use the machine during thunderstorms or lightning to avoid damage to the machine.
  - 16) Place the machine smoothly on the flame-retardant table and keep away from flammable and explosive items.
  - 17) Please stop using it if the machine smokes, emits a peculiar smell, or becomes noisy and in other abnormal conditions.
  - 18) This appliance can be used by children aged 8 years and above and persons with reduced physical, sensory or mental capabilities or lack of experience and knowledge

if they have been given supervision or instruction concerning use of the appliance in a safe way and understand the hazards involved. Children shall not play with the appliance. Cleaning and user maintenance shall not be made by children without supervision

2, Type X attachment: If the supply cord is damaged, it must be replaced by a special cord or assembly available from the manufacturer or its service agent.

3, In order to avoid a hazard due to inadvertent resetting of the thermal cutout, this appliance must not be supplied through an external switching device, such as a timer, or connected to a circuit that is regularly switched on and off by the utility.

## INTRODUCTION

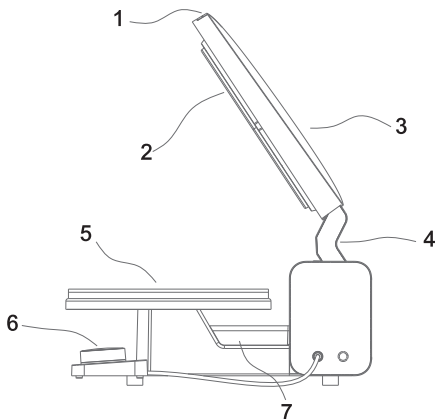

- 1.Start and stop buttons 2. Heating plate 3. Upper insulation shell  
4.Press down holder 5. Heat insulation pad 6.LED Display 7. Geared motor

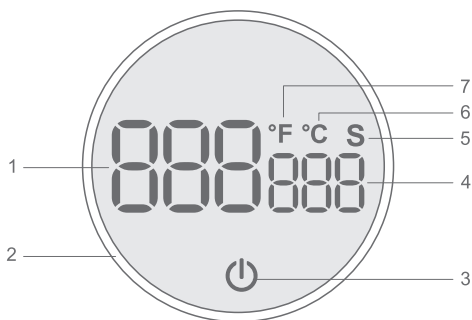

1. Temperature display 2. Knob switch 3. Start button  
4. Time display 5. Time unit 6. Centigrade 7. Fahrenheit

# Accessories list

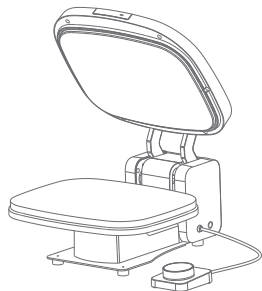

Main machine



Plate pad



Power cord



User manual

## Temperature unit conversion

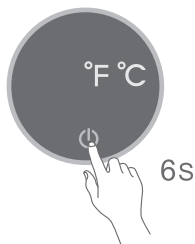

°F ⇌ °C

1. In shutdown state.
2. Press and hold the start button for 6s.
3. Turn the switch to select the required temperature unit.
4. Short press the start button to start the machine.

### Temperature setting



1. Turn the display half a turn to the right.
2. Enter the temperature setting mode after a beep sound.
3. Turn the switch to the right to increase the temperature (+).
4. Turn the switch to the left to reduce the temperature (-).



### Time setting

1. Turn the display half a turn to the left.
2. Enter the countdown setting mode after a beep sound.
3. Turn the switch to the right to increase the time (+).
4. Turn the switch to the left to reduce the time (-).

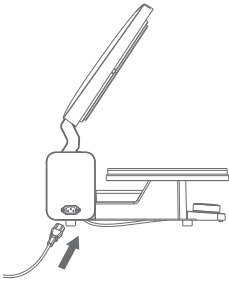

## Getting Started

1. Connect the power cord.  
then connect the power cord to the power port on the side of the machine and insert the other end into the AC socket.

### 2.Startup

After power on, short press the power button to start the machine.  
After startup, the machine will automatically heat up.

### 3.Shutdown

Press and hold the power button for 3s to shut down.

### 4.Auto shutdown

The machine will automatically shut down if there is no operation within 30min.



## Clothes printing process



Placing sequence of lower plate pad  
1. Top: White high temperature blanket  
2. Middle: Blue sponge

200 °C S  
60

Transfer material: Heat transfer paper  
Turn the switch to the right to set the temperature to 200°C.  
Turn the switch to the left to set the time to 60s.



170 °C S  
20

Transfer material: PET film  
Turn the switch to the right to set the temperature to 170°C.  
Turn the switch to the left to set the time to 20s.

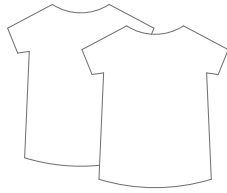

1. T-shirt to be printed.

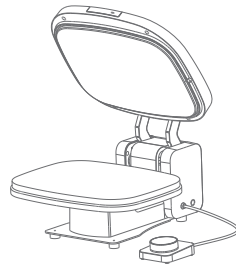

2. Turn on the heating plate to increase the temperature.

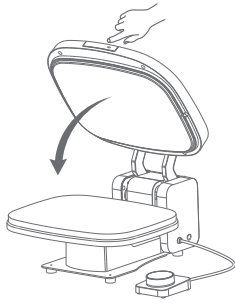

3. The heating plate automatically closes after pressing the button.

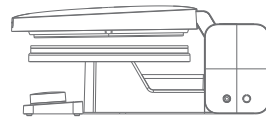

4. The machine automatically opens after countdown ends.

## Electrical diagram

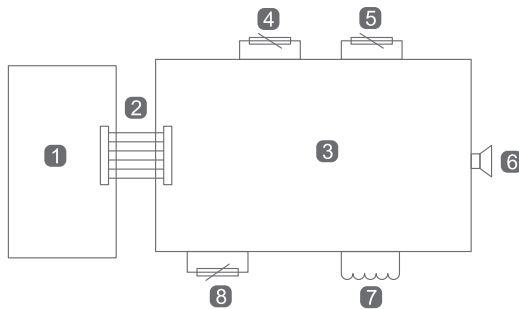

- |                              |                             |                |                          |
|------------------------------|-----------------------------|----------------|--------------------------|
| ❶ Main control circuit board | ❷ Flat cable for connecting | ❸ Power board  | ❹ NTC temperature sensor |
| ❺ Magnetic switch            | ❻ Buzzer                    | ❼ Heating coil | ❽ Thermal Fuse           |



# Wiring diagram of circuit board

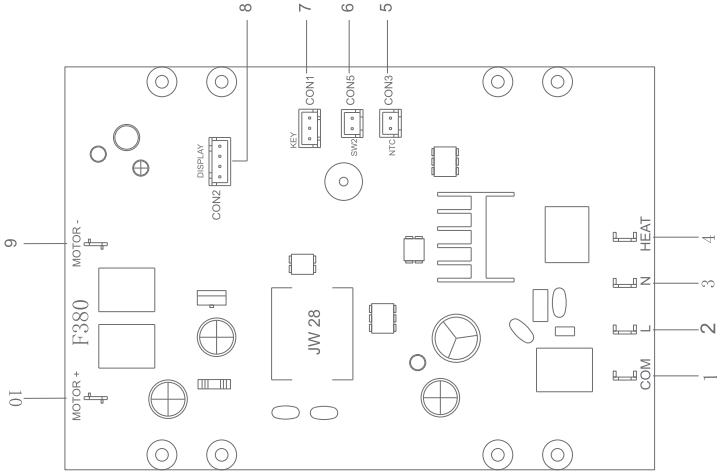

- |                      |                  |
|----------------------|------------------|
| 1. Output zero line  | 6. Sensor switch |
| 2. Input zero line   | 7. Button        |
| 3. Input live line   | 8. Display       |
| 4. Output live line  | 9. Motor-        |
| 5. Temperature probe | 10. Motor+       |

## PRODUCT PARAMETERS

Name: Heat press machine

Heating method: Mica heat

Rated voltage/frequency: 220-240V~ 50Hz 930W For European users

Rated voltage/frequency: 120V~ 60Hz 930W For US users

Temperature range: 40°C-205°C(104°F-401°F) Time range: 1-999s

Model: F380

Heating plate size: 290mmx380mm

## WARRANTY

Type	Items	Period
Whole machine	Parts of machine (excl. accessories)	1 year

## COMMON FAULT ANALYSIS

Fault phenomenon	Faults Causes and Solutions
Display error	F1: The temperature sensor is broken. If no display upon startup, please check whether the power cable is tightly connected to the socket.
Loft error	1. The motherboard and the motor link line off. 2. The circuit board cannot be powered. 3. Motor failure.
The main engine can not be heated	1. One-time temperature insurance fuse. 2. The main board can not power supply. 3. Heating plate damage.

Manufacturer: Yiwu Sunmeta Technology. Co., Ltd  
Address: NO.5 Xinpan Road, Shangxi Toen, Yiwu City, Zhejiang province, China

UK Importer: FREE MOOD LTD

Address: 2 Holywell Lane, London, England, EC2A 3ET

EU Importer: WAITCHX

Address: 250 bis boulevard Saint-Germain 75007 Paris

UK	REP	EUREP UK LTD UNIT2264, 100 OCK STREET, ABINGDON OXFORDSHIRE ENGLAND OX14 5DH
----	-----	--

EC	REP	EUREP GmbH Unterlettenweg 1a, 85051 Ingolstadt, Germany
----	-----	--

**Made in China**



**VEVOR**<sup>®</sup>

**TOUGH TOOLS, HALF PRICE**

Support and E-Warranty Certificate

<https://www.vevor.com/support>