

# Flood Barrier

## 1. Product description

- a) Material: Industrial grade PVC
- b) Dimensions: 24 ft x 10 in x 9 in / 24 ft x 20 in x 12 in / 12 ft x 20 in x 12 in
- c) Can be reused season after season
- d) 12 feet suitable for single-car garage and sliding doors
- e) 24 feet is best for large garage doors and create long barriers

## 2. Operation attention

- a) Water injection method

Unscrew the valve

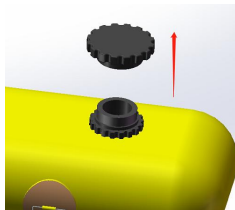

- b) Insert the water pipe into the valve, as deep as possible, open the water pipe valve to fill water

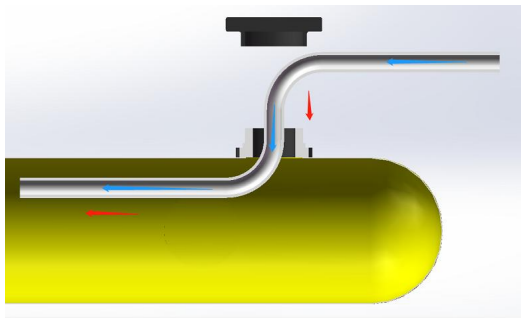

- c) Finally, when the flood control barrier reaches a suitable height, the water pipe is drawn out and the valve is locked.

## 3. Fixed

In order to better fix the flood barriers, we designed a fixed mechanism to prevent the flood barriers from being moved in larger water currents.

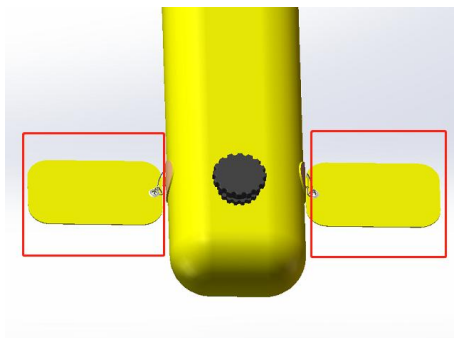

The PVC sheets on both sides are connected to the D-rings of the main body of the water bag with grommets. When the water bag is filled with water, the PVC sheets can be placed on both sides and pressed with heavy objects to fix the flood protection barrier.

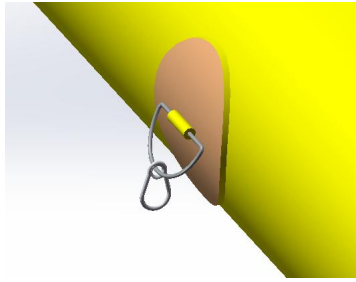

Or it is not necessary to install the PVC sheet, hang the gourd hook and use the rope to fix the flood protection barrier, which can be adjusted according to the needs.

#### 4. Storage

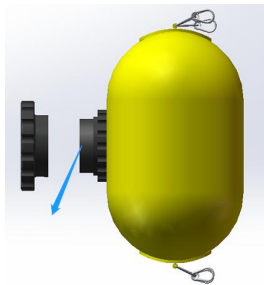

If you want to put away the flood barrier, please try to choose dry and windy weather, turn the valve of the water bag to one side, loosen the valve to drain, and let the water drain completely before letting it dry.

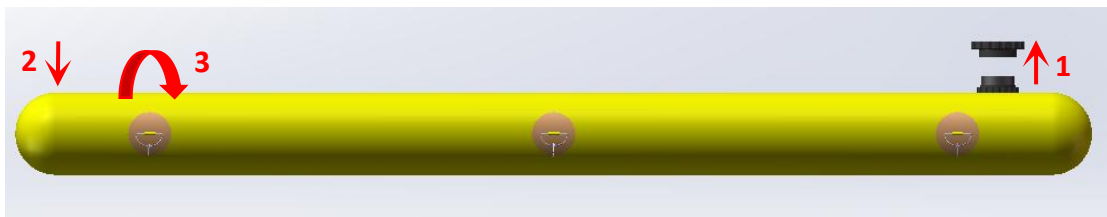

When storing, first unscrew the valve cover, flatten the end as much as possible, roll up the flat part of the water bag toward the valve, and squeeze out the air in the water bag a little bit, and finally complete the entire water bag. Tighten the valve cover after rolling up and store in a cool place

#### 5. Precautions

- a) Flood barriers need to be stored or used away from sharp and sharp objects
- b) Flood barriers need to be stored in a cool and dry place, not in high temperature or sunlight
- c) Before storage, you need to drain the water in the water bag as far as possible to air dry to prevent the next use of the peculiar smell
- d) After moving the flood control barrier after filling with water, please do not pull the gourd hook to prevent damage to the fixing ring
- e) Try not to move the flood barrier in low temperature or icing conditions, and at the same time, do not bend the flood barrier to prevent rupture due to low temperature movement and bending