



WIRE BINDING MACHINE MANUAL

12 MONTHS GUARANTEE

WE OFFERS PRODUCTS OF THE HIGHEST QUANTITY SHOULD ANY DEFECT APPEAR WITHIN 12 MONTHS OF DATE OF PURCHASEE~ PLEASE RETURN THE PRODUCT WITH PROOF OF PURCHASE TO US, AND WE WILL REPAIR OR REPLACE IT FREE OF CHARGE.. THIS GUARANTEE DOES NOT AFFECT YOUR STATUTORY RIGHTS.

⚠ ATTENTION

1. Read this operation manual carefully before using.
2. Keep the machine separately from children.
3. Keep the machine away from fire and liquid.
4. Put the machine on a stable and safe place in order to prevent if from falling or causing any injury to people or the machine itself.
5. Test the machine with some scrap paper before formally punching and binding, to make sure whether the position is correct to punch.



OPERATION GUIDE



SPARE PARTS LIST



SPECIFICATIONS

Manual Wire Binding Machine

Maximum 12 sheets (80g paper) per manual punch;
Maximum Binding Capacity: 120 sheets (80g paper);
Max. Binding Width: Below 300mm;
Adjustable Margin: 2.5, 4.5, 6.5mm;
Number of holes: 34 holes;
Hole Distance: 8.47mm
Size of Machine: 375x260x120mm;
Net Weight: 6.3kgs;

OPERATION GUIDE

PLACE THE MACHINE ON A STABLE AND SAFE PLACE BEFORE USING.

Caution: You must put the knob pointer at the right position "0" when you are punching

Punching and binding operation

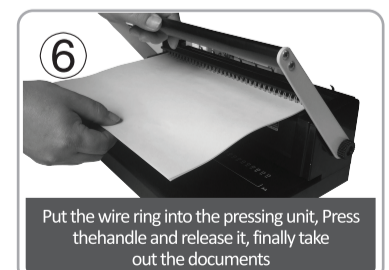
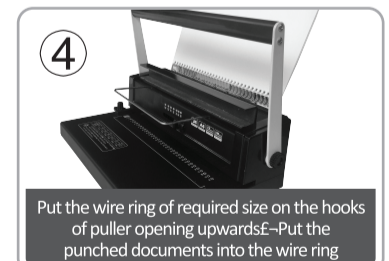

Clean up the waste paper box

1. Pull out the waste paper box from the bottom of the machine, clean it and insert it back again.
2. Please clean up the waste paper box frequently.