

VEVOR®

CUP TURNER
User Manual

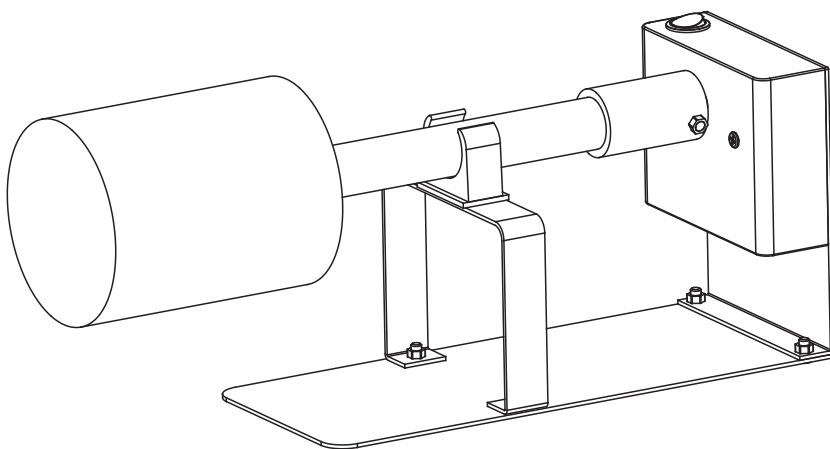

NEED HELP? CONTACT US!













Have product questions? Need technical support? Please feel free to contact us:







CustomerService@vevor.com

This is the original instruction, please read all manual instructions carefully before operating. VEVOR reserves clear interpretation of our user manual. The appearance of the product shall be subject to the product you received. Please forgive us that we won't inform you again if there is any technology or software updates on our product.

SAFETY PRECAUTION

 WARNING	Improper operation can result in injury. Improper operation may cause damage to the machine.
	This symbol indicates that the user should attach great importance to and pay attention to the triangular pattern. The left picture means "Beware of electrical shock".
	This symbol indicates forbidden. The left picture means "No disassemble".
	Do not use the power supply that does not meet the rated voltage. Use of a non-compliant power supply may result in fire or electric shock.
	When the machine smokes, emits peculiar smell, motor becomes noisy and other abnormal circumstances happens, please stop using. Keep using may cause fire or electric shock.
	It is forbidden to unplug the power supply when the machine is working. This will damage the machine.
	Ensure that the machine is grounded. Otherwise, electric shock or mechanical failure may occur.
	Do not disassemble, repair or correct the machine during use. Doing so can cause fire or electric shocks that can injure people.
	Attention
	Do not use in wet environment or contact with water. Do not infiltrate the liquid inside the machine, which will lead to short circuit and fire or electric shock.
	Do not touch the rotating rod or bearing part with your finger during use. This can cause finger injuries.
	Do not destroy or change the original power cord at will. Do not bend, pull, bind or press the power cord under heavy objects.

	If the machine will not in use for a long time, please unplug the power cord.
	Leakage protection switch devices must be installed for connecting sockets.
	The machine should be used on a firm, horizontal surface. Otherwise, the machine will fall, the use effect is not good, and even lead to injury.
	It is necessary to put the machine on a stable horizontal table when using it, otherwise the machine may fall down and even cause personal injury.
	Do not use the machine during thunderstorms and lightning, so as not to damage the machine.

PRODUCT DESCRIPTION

Technical Parameters

	EU	US	AU
Brand	VEVOR		
Model	KH-D101-1	KH-D101-2	KH-D101-3
Voltage	AC 220-240V	AC 120V	AC 220-240V
Frequency	50/60Hz		
Power	4W		
Rotation Speed	3-4RPM		
Package Size	270*130*170MM		
Net Weight	1.5KG		
Gross Weight	1.7KG		

Standard Accessories

Number	Item	Quantity	Diagram
1	Baseboard	1	
2	Mainframe	1	
3	Phosphor powder	1	
4	Holder	4	
5	Rotary Rod	2	
6	3 in 1 Foam	1	
7	Oversized Foam	1	
8	Small-sized Foam	1	
9	Silicone Brush	1	
10	100ml Plastic Cup	4	
11	Nitrile Gloves	4	
12	Silicone cap	8	
13	Silicone Case	8	
14	Wood Pin	9	
15	Rubber Pad	1	
16	Stirring Rod	15	
17	Wrench	1	
18	Philips Screwdriver	1	
19	Drying Rack Kit	1	
20	M4 Countersunk Screw	4	
21	M4 Nut	4	
22	Epoxy AB glue	2	

Product Structure

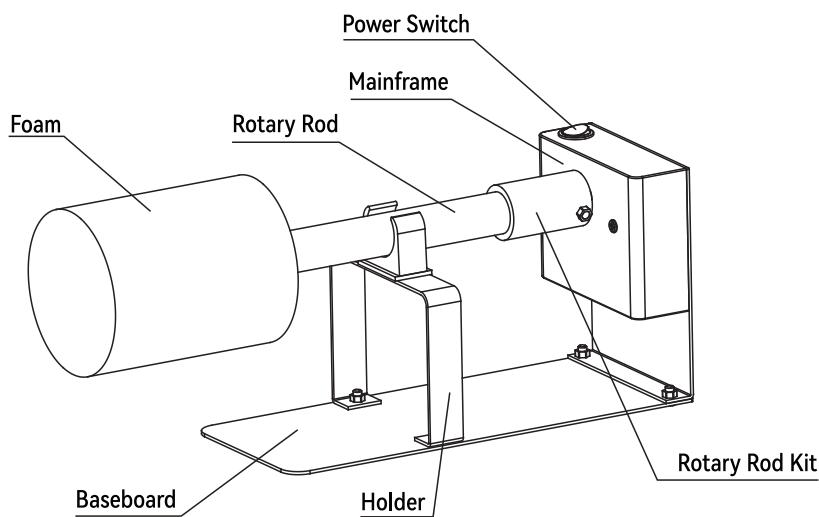

INSTALLATION AND INSTRUCTION

Tips!

Prepare these tools in advance:
Phillips screwdrivers, small wrenches, M4 countersunk screws, and M4 nuts.

(1) Install the baseboard, as shown in the figure.

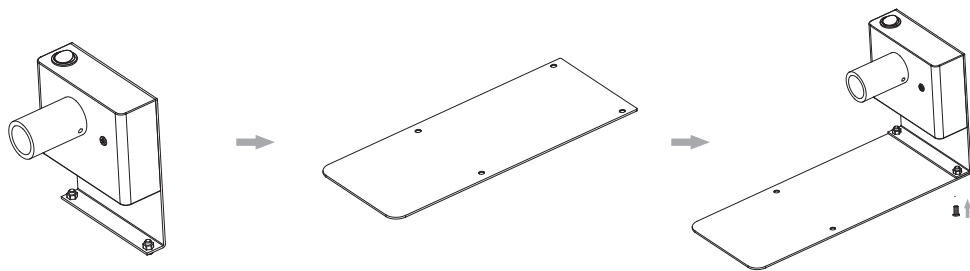

Prepare 2 pieces of M4 countersunk head screws and 2 hexagonal nuts.

(2) Install the holder kits, as shown in the figure.

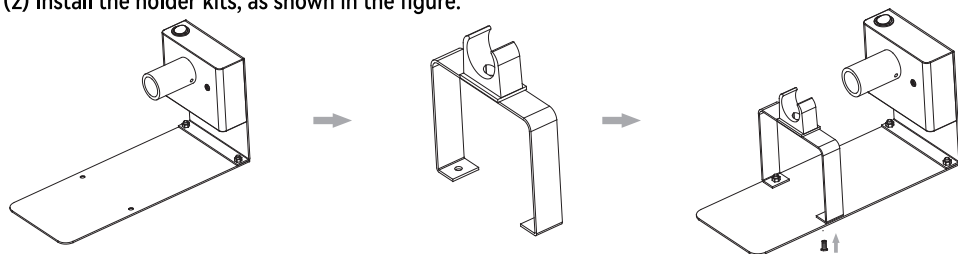

Prepare 2 pieces of M4 countersunk head screws and 2 hexagonal nuts.

(3) Install the rotary rods, as shown in the figure.

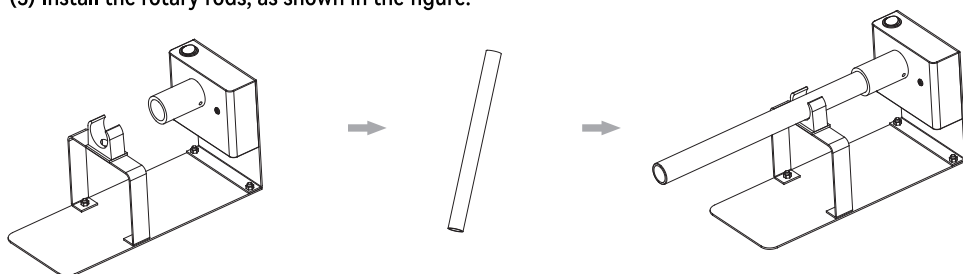

(4) Install the foams, as shown in the figure.

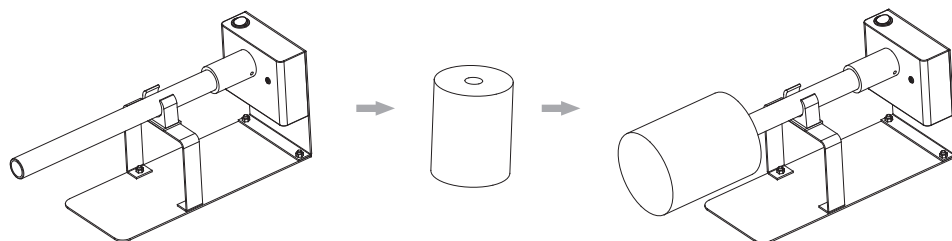

(5) Install the drying rack as shown in the following figure.

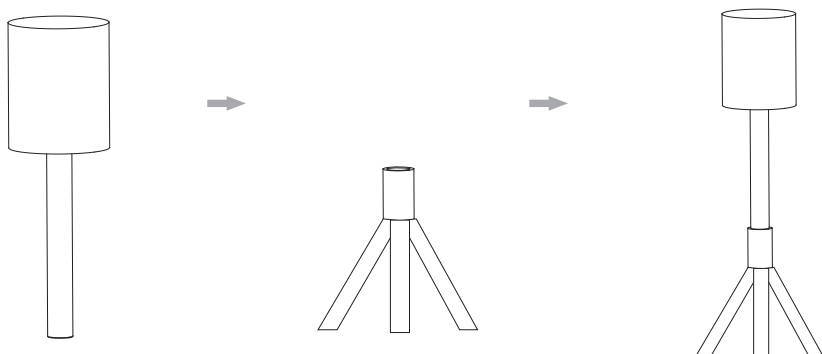

Tips!

- (1) The motor supports dual rotation directions, but the direction can not be selected.
- (2) The direction of motor rotation is affected by resistance. When the resistance is greater than the other direction, the steering direction will rotate to the direction with small resistance.
- (3) When restarting after power failure, the direction is not fixed.

Type Z CONNECTION:

The supply cord cannot be replaced. If the cord is damaged the appliance should be scrapped.

GUIDE FOR BEGINNERS

1. Fix the cup and turn on the machine.
2. Mixed epoxy resin (AB glue in 1:1 ratio).
3. Brush epoxy resin on the cups.
4. Brush with glitter or paint as needed and wait 4 hours.
5. Brush with epoxy again and wait 8 hours.
6. Sand the surface as needed.

Note:

The above steps are only for reference.

The specific operation will vary according to the actual spraying requirements.

Cleaning Guidelines of Epoxy

- (1) The epoxy resin is not completely solidified (soft state), just wipe with water or alcohol for cleaning.
- (2) The epoxy resin has solidified and hardened. Blow it with a hair dryer or heat gun and wipe it with alcohol for cleaning.

Note:

- (1) When mixing epoxy, please use a heat gun or air dryer to speed up the mixing and make the mixture more uniform.
- (2) Using a heat gun or a hair dryer to blow the surface of the cup after it has been coated with epoxy will reduce problems such as air holes and other defects.

APPLICATION RANGE

Cup Painting



Pen Painting

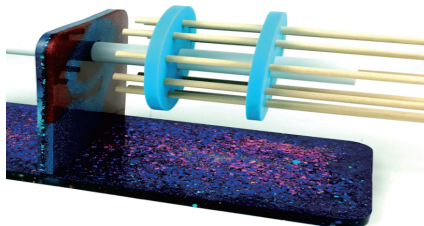

COMMON FAULT ANALYSIS

Problems	Causes	Solution
Machine doesn't work.	Machine cannot be powered on.	Check whether the power switch is turned on and whether the power cord is damaged (contact the after-sales service).
Rotary rod falls off when in use.	Rotary rod is not securely inserted.	Check whether the installation is in place before use, or check whether the machine is used horizontally.
Rotary rod is loose and shaking / abnormal noise	Rotary rod is not properly installed.	Rotary rod screws must be tightened.
Cup dislodged from the foam.	Cup doesn't match the foam.	Check whether the assembly is in place, check the size of the foam and cup, if not suitable, please replace in time.



Dispose:

This product is subject to the provision of European Directive 2012/19/EC.

The symbol showing a wheeled bin crossed through indicates that the product requires separate refuse collection in the European Union. This applies to the product and all accessories marked with this symbol. Products marked as such may not be discarded with normal domestic waste, but must be taken to a collection point for recycling electrical and electronic devices.

Manufacturer: Zhongshan Qixiang Electrical Appliance Co., Ltd.
Address: No.5, 12 Bihua Road, Baishi Village, Sanxiang Town, Zhongshan City, Guangdong Province China

EU Importer: WAITCHX
Address: 250 bis boulevard Saint-Germain 75007 Paris
UK Importer: FREE MOOD LTD
Address: 2 Holywell Lane, London, England, EC2A 3ET

EC	REP	EUREP GmbH Unterlettenweg 1a, 85051 Ingolstadt, Germany
UK	REP	EUREP UK LTD UNIT 2264, 100 OCK STREET, ABINGDON OXFORDSHIRE ENGLAND OX14 5DH

VEVOR[®]

E-mail: CustomerService@vevor.com