

**VEVOR<sup>®</sup>**

# **Portable Workbench**

**LCWB90  
USER MANUAL**



# VEVOR<sup>®</sup>

## *Portable Workbench*

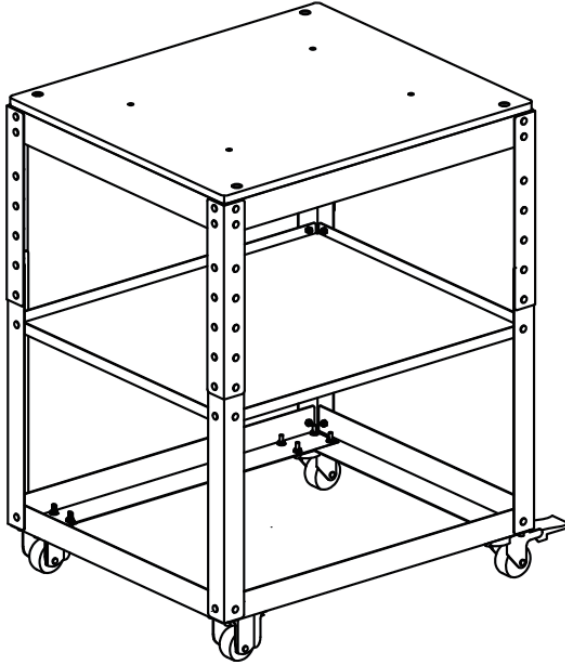

### **NEED HELP? CONTACT US!**

Have product questions? Need technical support? Please feel free to contact us:



**CustomerService@vevor.com**

This is the original instruction, please read all manual instructions carefully before operating. VEVOR reserves clear interpretation of our user manual. The appearance of the product shall be subject to the product you received. Please forgive us that we won't inform you again if there is any technology or software updates on our product.

## GENERAL SAFETY RULES

**IMPORTANT:** carefully read the instructions in this manual as well as the general safety instructions before using this tool.



Before using the tool, read the instruction book carefully.

**WARNING !** Read the instructions and use or operate without following the instructions listed below will result in deformation, inflexible movement, loss of bearing weight or serious injury.

## WORKPLACE

- 1) Keep the workplace clean and bright. A messy and dark place can cause accidents.
- 2) Do not expose the workbench to rain or wet environment.
- 3) Pay attention to whether the ground is smooth when working outdoors to prevent tilt and collapse.

## PORTABLE WORKBENCH USE AND PRECAUTIONS.

- 1) Check whether the screws and nuts are tightened to prevent collapse during use.
- 2) When preparing for work, check whether the universal wheel is locked to prevent sliding during use.
- 3) Use safety devices. Always wear gloves.
- 4) Maintain the portable workbench, check the installation deviation of the moving parts, whether it is stuck, screw damage and other conditions affecting the operation of the portable workbench, such as damage, portable workbench must be repaired before use, many accidents caused by poor maintenance.

## MAINTENANCE

1) Send your portable workbench to professional maintenance personnel, must use the same spare parts for replacement, this will ensure the safety of use after maintenance.

## PRODUCT PARAMETER

Model	LCWB90	
Length	700	mm
Width	600	mm
Maximum Adjustable Height	900	mm
Medium Adjustable Height	850	mm
Minimum Adjustable Height	800	mm
Load Limit	100	lbs
G.W	25.4	kg
N.W	21.9	kg

## STRUCTURE AND PART NAME

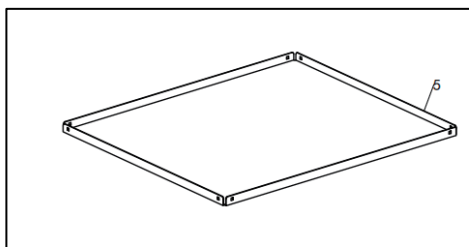
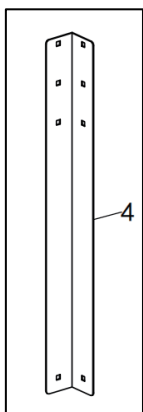
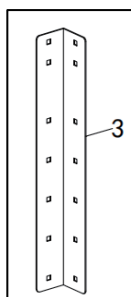
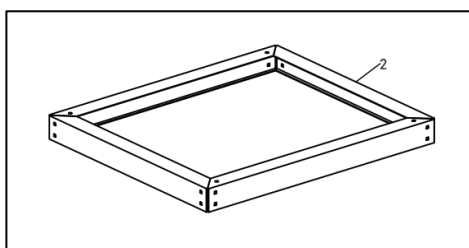
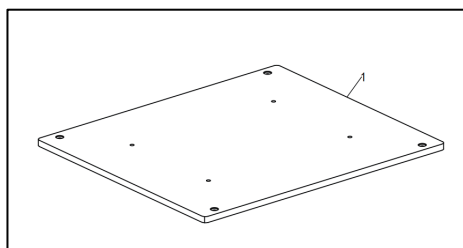
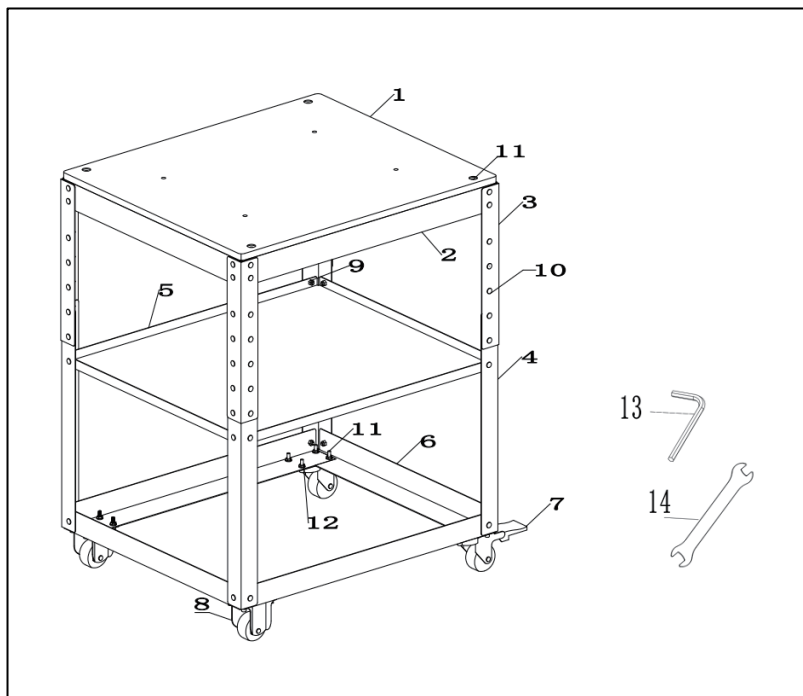

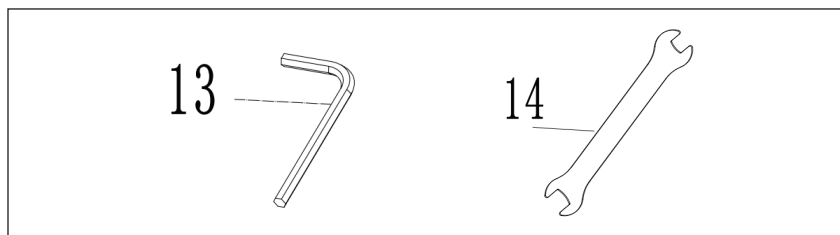
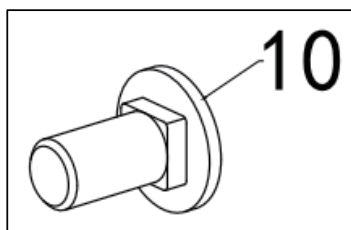
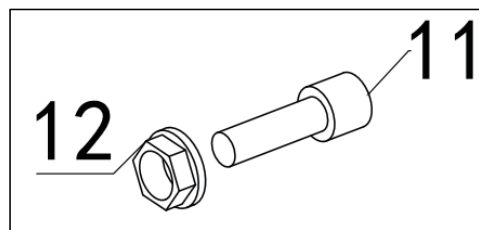
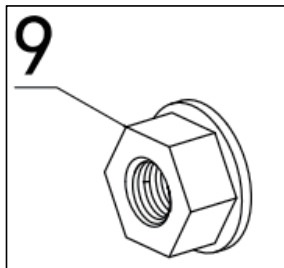
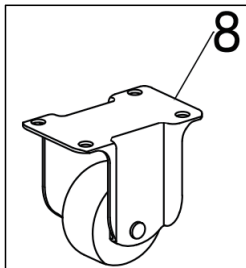
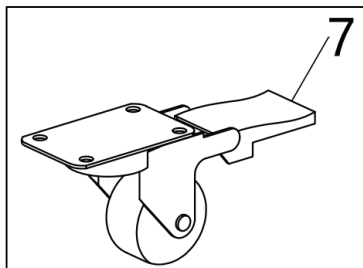
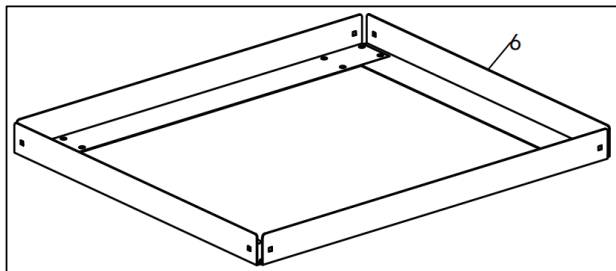

### Name of Parts:

1: Platform

2: Panel

3: WB90 Column

4: WB90 Column

5: Bulkhead

6: Bower Bulkhead

7: Universal Wheel

8: Directional Wheel

9: M6 Flange Nut

10: M6 Carriage Screws

11: M8 Hex Socket Screws

12: M8 Flange Nuts

13: Inner Hexagonal Wrench

14: 13-10 Open End Wrench

## ASSEMBLE STEPS

### STEP. 1

Put 11 (M8 hex screw) into 7 (universal wheel) and 8 (universal wheel) screw holes and then screw 12 (M8 flange nut) into them with 13 (hex wrench 6) and 14 (13-10 open end wrench) to tighten and fix them.

### STEP. 2

Put 10 (M6 carriage screw) into the screw hole of 4 (WB90 column 2) and screw 9 (M6 flange nut) into it with 14 (13-10 open wrench) to tighten and fix it.

### STEP. 3

Put 5 (divider) into 4 (WB90 column 2), put 10 (M6 carriage screw) into its screw hole, and screw 9 (M6 flange nut) into it with 14 (13-10 open end wrench) to tighten and fix it.

### STEP. 4

Fix 3 (WB90 column 1) After the remaining two holes in its 4 (WB90 column 2), put 10 (M6 carriage screw) into it, and then screw in 9 (M6 flange nut) with 14 (13-10 open wrench) to tighten and fix it.

### STEP. 5

Fix 2 (panel) into 3 (WB90 column 1) to its screw holes, and then put 10 (M6 carriage screw) into the top two holes, and then 9 (M6 flange nut) into the 14 (13-10 open end wrench) to tighten and fix it.

### STEP. 6

Put 1 (bench) on the 2 (panel) after the screw hole, then put 11 (M8 hex screw) into the four holes, and then screw 12 (M8 flange nut), use 13 (hex wrench 6) and 14 (13-10 open wrench) to tighten and fix it.



## ADJUST THE HEIGHT

1) The maximum height is 900mm as shown in the figure below. 1.2.3 in 3 (WB90 column 1) and 4 (WB90 column 2). The holes are aligned, and 10 (M6 carriage screws) and 9 (M6 flange nuts) are put in and tightened with 14 (13-10 open spanner).

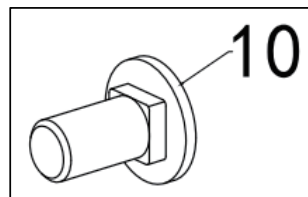
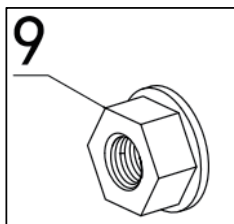
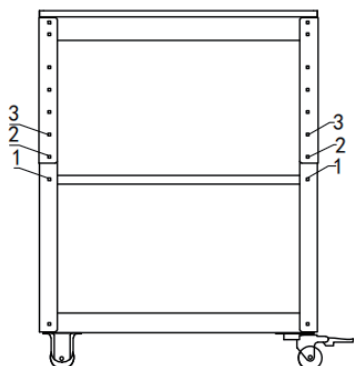

2) Medium height 850mm as shown below: 2.3.4 in 3 (WB90 column 1) and 4 (WB90 column 2) as shown below. The holes are aligned, and 10 (M6 carriage screws) and 9 (M6 flange nuts) are put in and tightened with 14 (13-10 open spanner).

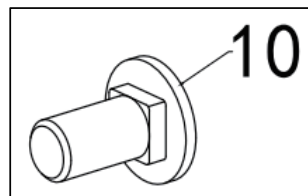
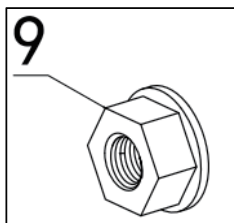
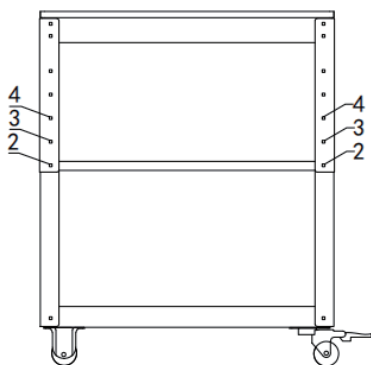

3) The minimum height of 800 is shown as follows: 3.4.5 in 3 (WB90 column 1) and 4 (WB90 column 2) as shown below. The holes are aligned, and 10 (M6 carriage screws) and 9 (M6 flange nuts) are put in and tightened with 14 (13-10 open spanner).

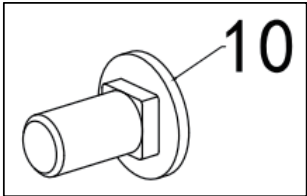
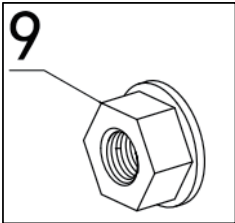
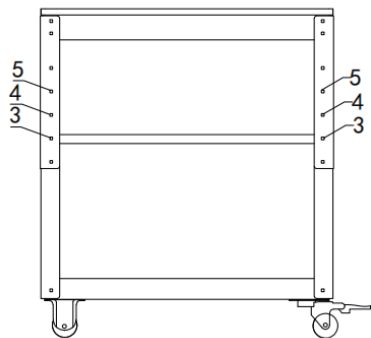

Manufacturer: ZHEJIANG LANGCHENG INDUSTRY&TRADE CO., LTD  
Address: No.18 Weisan East Road, Hardware Machinery Industrial Zone,  
Tongqin Town,Wuyi County, Jinhua City 321201 Zhejiang, P.R.China  
Importer: WAITCHX  
Address: 250 bis boulevard Saint-Germain 75007 Paris  
Importer: FREE MOOD LTD  
Address: 2 Holywell Lane, London, England, EC2A 3ET  
MADE IN CHINA

**VEVOR<sup>®</sup>**

E-mail: [CustomerService@vevor.com](mailto:CustomerService@vevor.com)