

VEVOR[®]

**MITER SAW STAND
USER MANUAL**

YH-MS042C

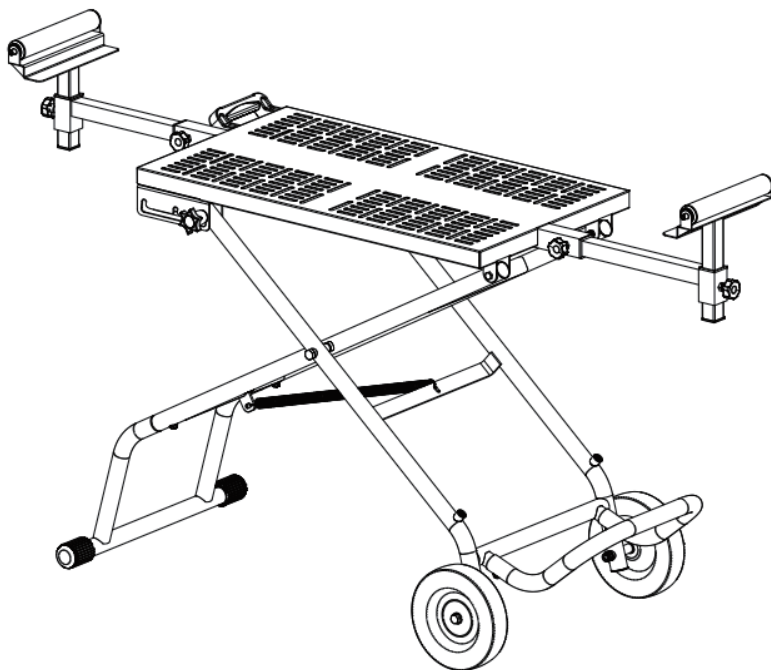

NEED HELP? CONTACT US!

Have product questions? Need technical support? Please feel free to contact us:

CustomerService@vevor.com

This is the original instruction, please read all manual instructions carefully before operating. VEVOR reserves clear interpretation of our user manual. The appearance of the product shall be subject to the product you received. Please forgive us that we won't inform you again if there is any technology or software updates on our product.



Warning-To reduce the risk of injury, user must read instructions manual carefully.

TOOLS NEEDED

The following tools (not included) are needed to assemble the miter saw stand:

- 1 -Phillips screw driver (handle, leg extension and foot assembly)
- 2- Adjustable wrenches or two 19 mm wrenches(wheel assembly)

ITEM	DESCRIPTION	QTY
A	Main Frame	1
B	Extension Rail	1
C	Leg Extension	1
D	Foot	1
E	Wheels	2
F	Roller Bars	2
G	Handle	1
H	Locking Knobs	4
I	Locking Knobs (star)	2

ITEM	DESCRIPTION	QTY
J	PH screw M6x8	1
K	Hex Bolt (M12x110 mm) (wheel)	2
L	Hex locking nut M12 (wheel)	2
M	Phillip Pan Head Screw M6x35 (handle)	2
N	Curved Washer (leg extension/foot)	4
O	Phillip Pan Head Screw M6x12(leg extension/foot)	4
P	Miter Saw Mounting Hardware (mounting bolt, washer, lock washers and nut)	4

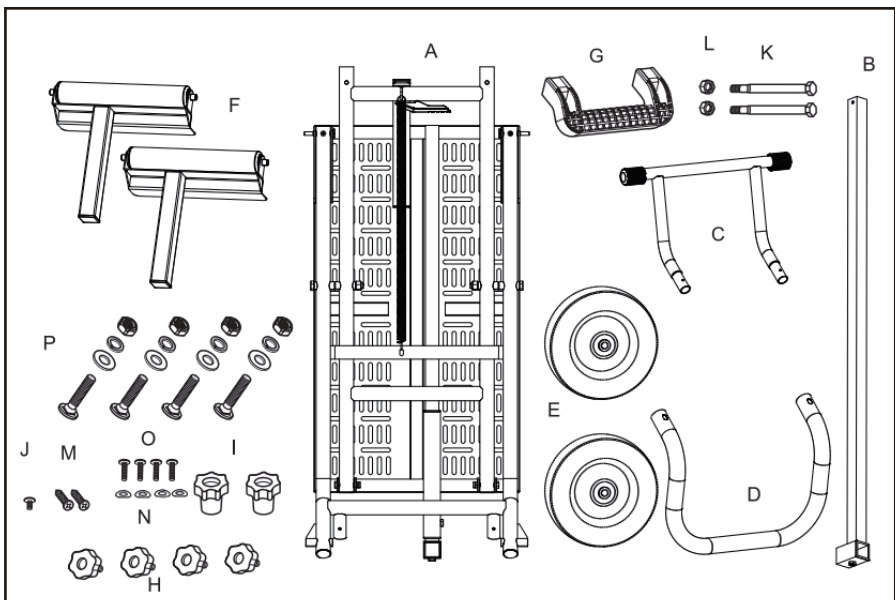

ASSEMBLY

Refer to Figure

- Insert the extension rail into the table top and screw on PH screw M6x8
- Place the main frame onto the table top as shown. Slide leg extension into main frame and secure with curved washers and pan head screws.
- Lift the main frame and slide foot into main frame and secure with curved washers and pan head screws.
- Slide the hex bolt through the wheel and main frame leg. Secure with hex locking nut on the inside of main frame. DO NOT overtighten, if too tight the wheels will not turn, Repeat with other wheel.
- Thread the locking knob (star shaped) onto the adjusting bracket screw. Repeat on other side. DO NOT tighten the locking knobs at this time.

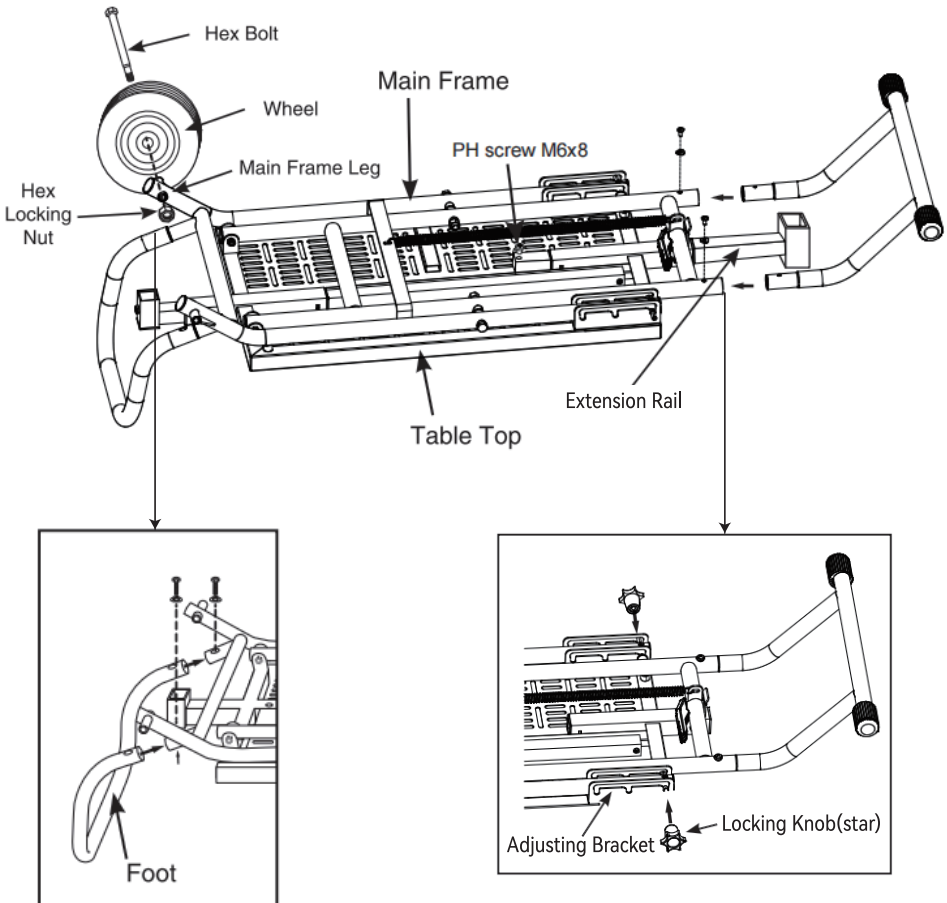

- Turn the stand over to rest on the leg extension and wheels.
- Place one foot on the leg extension to hold the stand in place. Depress the release lever, lift and slightly pull the table top towards you and raise the table top until it latches in place. Tighten the locking knobs on each side.
- Place the roller arm into the roller bar support, slide up and down to desired location and secure in place with roller bar locking knobs.
- Thread the extension bar locking knobs into the extension bar. Repeat on other side.

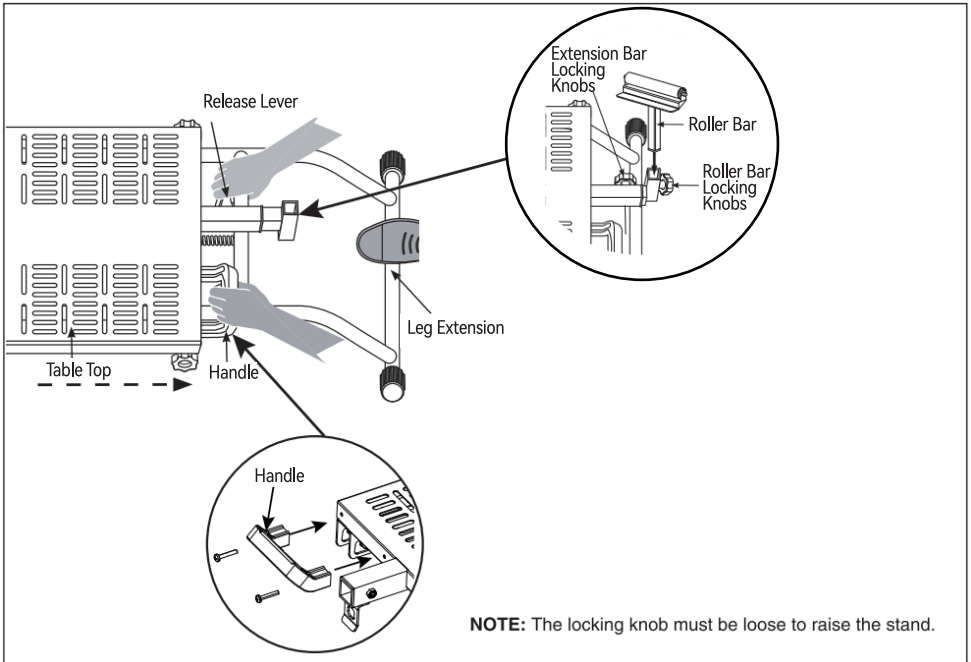

- Place the miter saw to be used on the table top.
- Move the miter saw around until the hole pattern matches the slot combination on the table top, secure with the mounting hardware supplied.
- Insert the bolt through the bottom of the table and secure with flat washer, lock washer and nut.

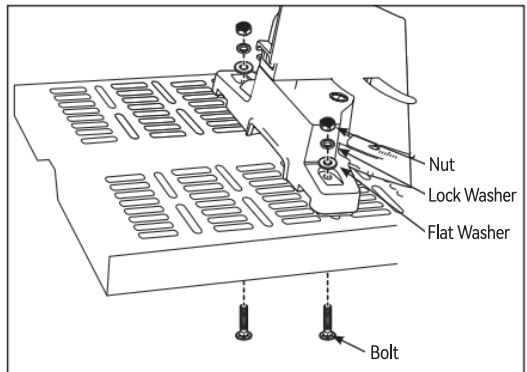

ROLLER/EXTENSION BARS ADJUSTMENT

Refer to Figure

The extension bars move in and out to properly support the work piece. The roller bars are used as directional rollers or with the extension bars as stationary stop guides.

- Loosen the extension bar locking knobs, slide the extension bar in or out to the required position, tighten the extension bar locking knobs.
- Loosen the roller bar locking knobs, slide the roller bars up and down to desired location, tighten the roller bar locking knobs.

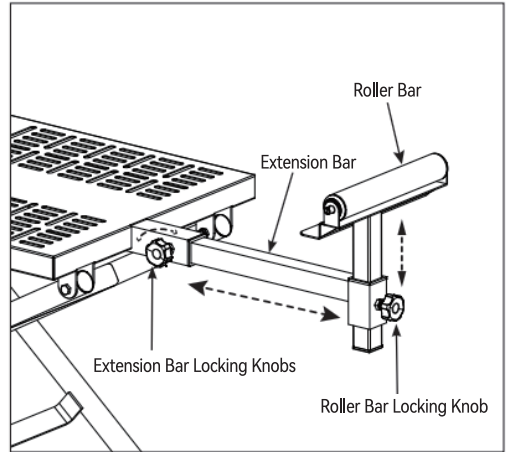

TO RAISE AND LOWER THE STAND

Refer to Figure

The stand has three positions

Position 1: Work Height (82 cm)

Position 2: Work Height (68 cm)

Position 3: Storage/Transport Position

- Loosen the locking knobs on the adjusting brackets, both sides.
- Place one foot on the leg extension to hold the stand in place.

To raise

- Depress the release lever, lift and slightly pull the table top towards you and raise the table top.

To raise

- Lift and slightly push the table top away from you and lower the table top.
- Position the locking knob into one of the three positions and tighten on each side.
- To move the stand, use handle to lift and tilt the miter saw stand onto the wheels. Move miter saw stand as shown.
- Holding the handle, carefully lower the stand to the ground.
- The stand may be stored in the vertical or horizontal position.

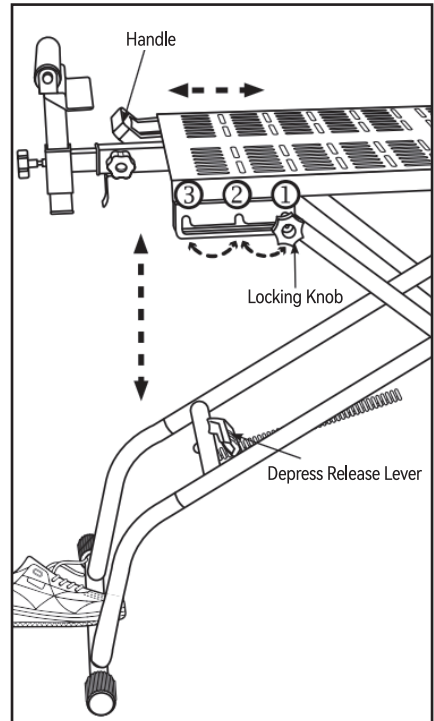

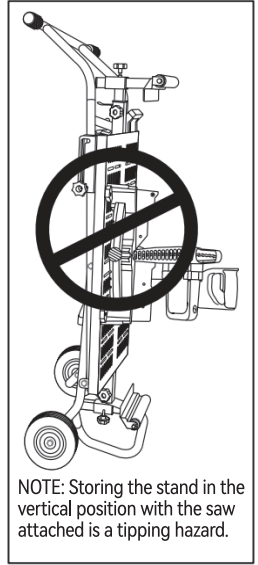
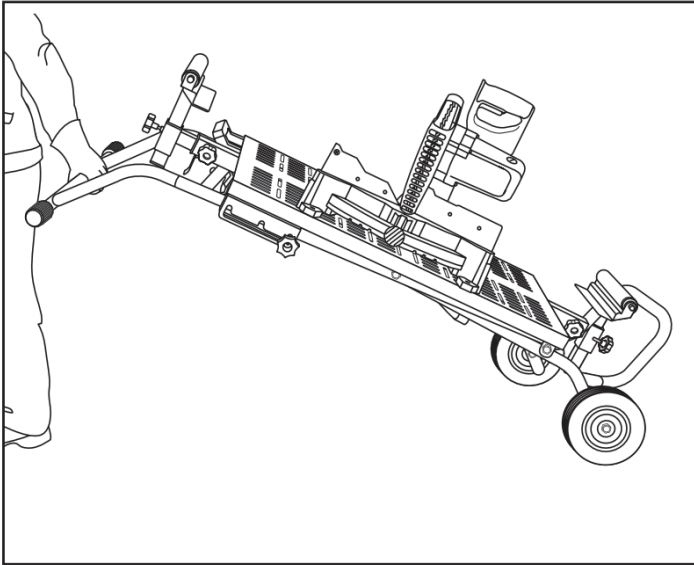

NOTE: Storing the stand in the vertical position with the saw attached is a tipping hazard.

Miter Saw Stand						
1	Model	YH-MS042C	YH-MS050C3	YH-MS056B	YH-MS055F-1	YH-MS055-1
2	Load Limit	250kg	150kg	225kg	150kg	150kg
3	Package size	1177×560×190mm	970×280×160mm	1290×290×190mm	1205×638×158mm	1205×638×158mm
4	G.W.:	27.4kg	12.9kg	18.3kg	26.1kg	26.1kg
5	Max Length	2500mm	1985mm	2640mm	/	/
6	Min Length	1260mm	940mm	1120mm	/	/
7	Extended Arm	Yes	Yes	Yes	No	No
8	Adjustable Height	Yes	No	No	Yes	Yes
9	With power strip	No	No	No	Yes	No

Manufacturer: Jinhua Yahu Tools Co., Ltd.

Address: No.1333 Jinyuan Road, 321000 Jinhua City, Zhejiang Prov.

Importer: WAITCHX

Address: 250 bis boulevard Saint-Germain 75007 Paris

Importer: FREE MOOD LTD

Address: 2 Holywell Lane, London, England, EC2A 3ET

Made in China

VEVOR[®]

E-mail: CustomerService@vevor.com