

VEVOR[®]

TOUGH TOOLS, HALF PRICE

Technical Support and E-Warranty Certificate www.vevor.com/support

1100LBS MOTORCYCLE LIFT USER'S MANUAL

MODEL: 110202

We continue to be committed to provide you tools with competitive price.

"Save Half", "Half Price" or any other similar expressions used by us only represents an estimate of savings you might benefit from buying certain tools with us compared to the major top brands and does not necessarily mean to cover all categories of tools offered by us. You are kindly reminded to verify carefully when you are placing an order with us if you are actually saving half in comparison with the top major brands.

VEVOR[®]

1100LBS
MOTORCYCLE LIFT

110202



<Picture Only For Reference >

PLEASE READ THIS MANUAL CAREFULLY BEFORE USE

NEED HELP? CONTACT US!

Have product questions? Need technical support? Please feel free to contact us:

 **CustomerService@vevor.com**

This is the original instruction, please read all manual instructions carefully before operating. VEVOR reserves a clear interpretation of our user manual. The appearance of the product shall be subject to the product you received. Please forgive us that we won't inform you again if there are any technology or software updates on our product.

1. Operation

1. Rotate the screw by ratchet wrench to adjust the height of the platform.
2. Adjust the platform to the appropriate height and place the lift to the bottom of the motorcycle. Make sure that the center of the load align with the pivot, and keep the load stable and safe.
3. When all this is done, lift the motorcycle to the proper height and insert the safety pin.
4. Tighten the motorcycle with other tools to keep it stable.
5. After repairing, pull out the safety pin, rotate the ratchet wrench slowly and gently to lower the platform until it departs from pivot, and then take the lift away.

2. PECIFICATIONS

Model	Rated capacity(LBS)	Minimum height(mm)	Maximum height(mm)	G.W.(kg)
110202	1100	89	338	15

3. CAUTION

1. Read and understand the user manual before assembling, installing, operating, or servicing this product. Failure to follow these warnings and instructions can cause death, personal injury or damage to valuable property. And Keep the user manual .
2. Do not overload the Engine Stand. Never exceed the maximum weight capacity of 1100 Lbs.
3. Keep the load stable and prevent the load from losing balance.
4. Before using, lubricate the screw and the nuts with grease to make the lift flexible and antifricition.
5. Use this lift for second-lift purpose only. Do not use it for any other purpose it is not designed to perform.
6. Keep children and unauthorized persons away from the work area.
7. Wear ANSI approved safety goggles when operating the lift.
8. Only use this lift on a big , stable ,level, dry and not slippery motorcycle

lift platform. Keep the surface clean, tidy and free from unrelated materials and ensure that there is adequate lighting.

9. Always keep your hands and feet away from working area.

10. Do not allow untrained persons to operate the lift .

11. Do not make any modifications to this lift.

4. MAINTENANCE

1. When not in use, the lift must be stored in the lowest position in a dry location.

2. Keep the lift clean and wipe off any oil or grease. Lubricate all moving parts.

3. Before each use check all parts. If any part of the lift is damaged or suspect , remove the lift from service and take necessary action to repair.

5. PARTS LIST

Part No	Description	Qty	Part No	Description	Qty
1	Platform	1	13	Washer M20	4
2	Bolt M12×50	2	14	Outside lifting arm	1
3	Washer M12	10	15	Connect pin	1
4	Saddle	2	16	Middle bush	1
5	Adjustable plate	2	17	Inside frame roller	2
6	Bolt M10×25	2	18	Inside lifting arm	1
7	Handle	1	19	Bearing	2
8	Lifting screw	1	20	Outside fixing spindle	1
9	Inside fixing spindle	1	21	Fixing nut	1
10	Spring blocking	4	22	Lock nut M6	1
11	Base plate	1	23	Inside removable spindle	1
12	Outside frame roller	2	24	Safety Pin	1

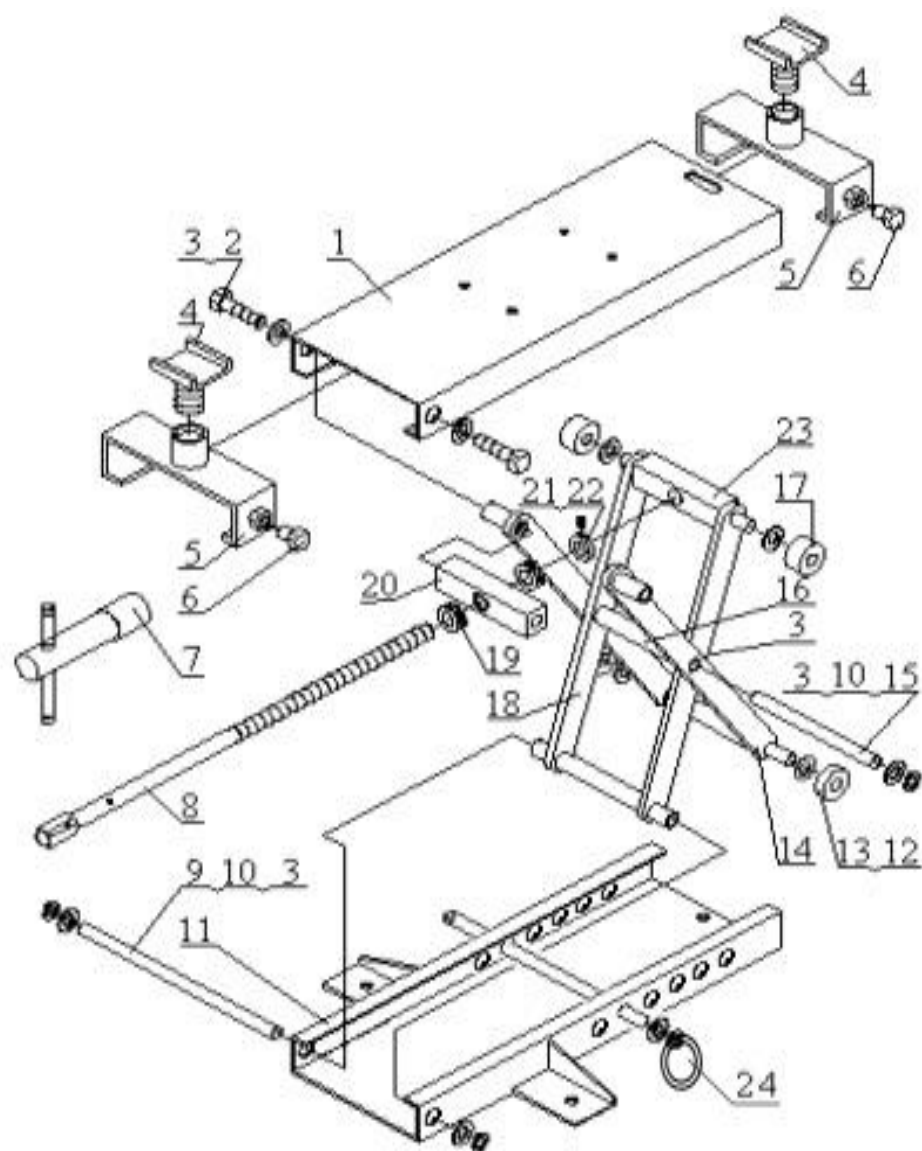

EU Importer: WAITCHX, 250 bis boulevard Saint-Germain 75007 Paris
UK Importer: FREE MOOD LTD, 2 Holywell Lane, London, England, EC2A 3ET



EUREP UK LTD
UNIT 2264, 100 OCK STREET, ABINGDON
OXFORDSHIRE ENGLAND OX14 5DH



EUREP GmbH
Unterlettenweg 1a, 85051
Ingolstadt, Germany

Manufacturer: Zhejiang Jinhong Auto Accessory Co., Ltd.
Address: No.36 Binhai Road, Jianshan, Haining, Zhejiang, China
MADE IN CHINA

VEVOR[®]

TOUGH TOOLS, HALF PRICE

Technical Support and E-Warranty Certificate

www.vevor.com/support

MADE IN CHINA