

Multifunctional Water Ionizer Operation Instruction



- Please read this manual before using this product
- Please use this product properly
- Please keep this instruction manual properly

Catalog

2 Product main features

3 Technical parameters and specifications

3 How to install

6 Controlling panel overview

7 Panel operation and features

8 General use pH instruction tables for water ionizer

9 The LCD display introduction

10 Principle of operation

10 Function setting

13 Precaution for use

13 Troubleshooting

Product Main Features

This Multifunctional Water Ionizer can be used freely in different water quality and different standards of the power supplies.

- 1.A large 3.8-inch colorful LCD screen display, displaying more information.
- 2.The LCD displays pH and ORP, flow rate, temperature, filter usage life, helping user to select suitable water.
- 3.Elegant and solid CDC Touch control panel, easy to be used by children & elderly people.
- 4.Using high-power SMPS power supply, it is suitable for many different power supplies in the world, safe and reliable.
- 5.The electrolysis with the Microcomputer automatic control system can work perfectly in the water TDS from 50 to 1000PPM.
- 6.It has a built-in water filtering system, showing the filter life span in time, to make sure the water quality is safe to use.
- 7.It has the self-cleaning function, to prevent scaling.
- 8.Japan imported stainless steel spouts, never rust, free to be bent to any direction.
- 9.large size Titanium with Platinum coating plates, applied with Japan imported ionic membrane, providing higher efficiency electrolysis and longer working life.
- 10.Built-in overheat protection system, prevents high temperature water from entering the machine, assure the machine.



Technical Parameters And Specifications

1	Power supply	(SMPS)AV110/220V,50~60Hz
2	Work power	5~90W
3	Bide power	1W
4	Water pressure	0.1~0.3MPa
5	Inlet water TDS	50~1000mg/L
6	Flow rate	0.8~3.5L/Min
7	Best flow rate	2~3 L/Min
8	Continuously working time	30minutes
9	Filter usage life	6000L(Depend on the water quality)
10	Plates material	Titanium with platinum coating
11	Plates size	79mm*43mm
12	Number of plates	5PCS (Default) / 7PCS
13	pH range	3.5-10.5
14	ORP range	+600~-500mV
15	Inlet water temperature	Lower than 45 Celsius degree
16	Machine weight	1.5KG
17	Machine size	258mm*170mm*110mm

Note: The pH & ORP range, Filter usage life and Flow rate etc is depending on your local water supply condition.

How To Install

Parts and Accessories :





Water Converter



Spout

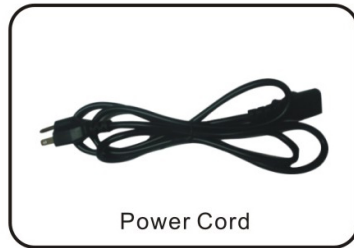

Power Cord

Tools you will need :



Utility Scissors

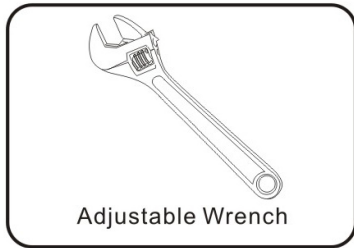

Adjustable Wrench

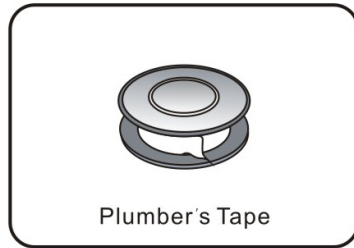

Plumber's Tape

Installing the hoses for the water:

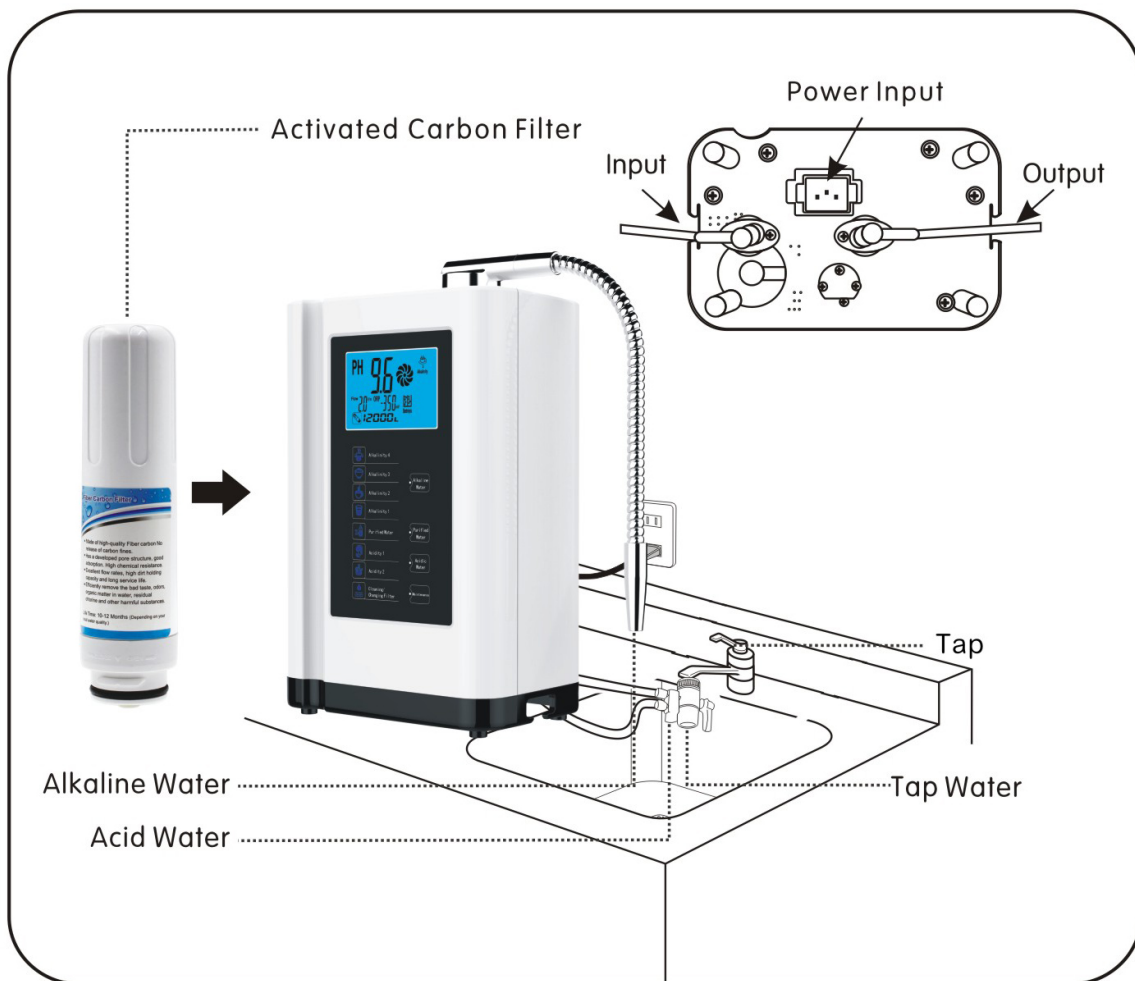



There are 2 water hoses. Insert one hose into the IN outlet on the back of the unit and the other end should be inserted into the top insert on the adaptor. Repeat the process for the OUT outlet to the bottom insert. When getting ready to insert other end of hose into the adaptor, first insert the hollow bolt through the hose and bolt screw the bolt into the adaptor as seen in the picture below.

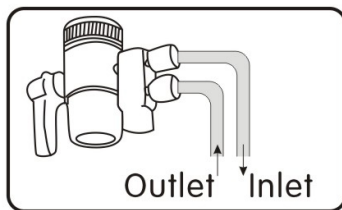

Insert the top hose to the out nozzle behind the unit and insert the bottom hose to the in nozzle. The hoses are identical, so either hose is affixed to which part of the adaptor will not matter.

How to connect the adaptor to 2 common types of faucets:

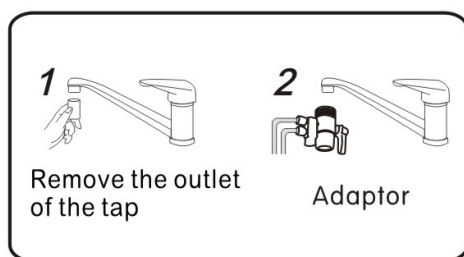

Type A:

Remove the outlet of the tap and fasten the adaptor. If there are leaks, turn it slightly as shown in the diagram until the leak stops, ensure that the washer has been inserted before tightening.

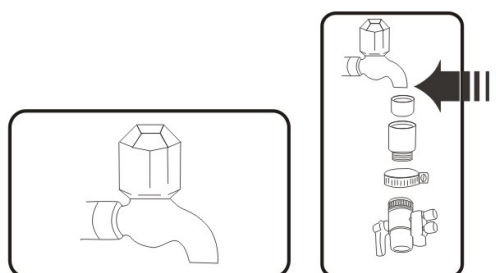

Type B:

Installation procedure (As shown on the left)

- Fix the installation ring first.
- Use the internal ring set and affix to the tap
- Tighten with a wrench
- Finally, affix the value

Controlling Panel Overview

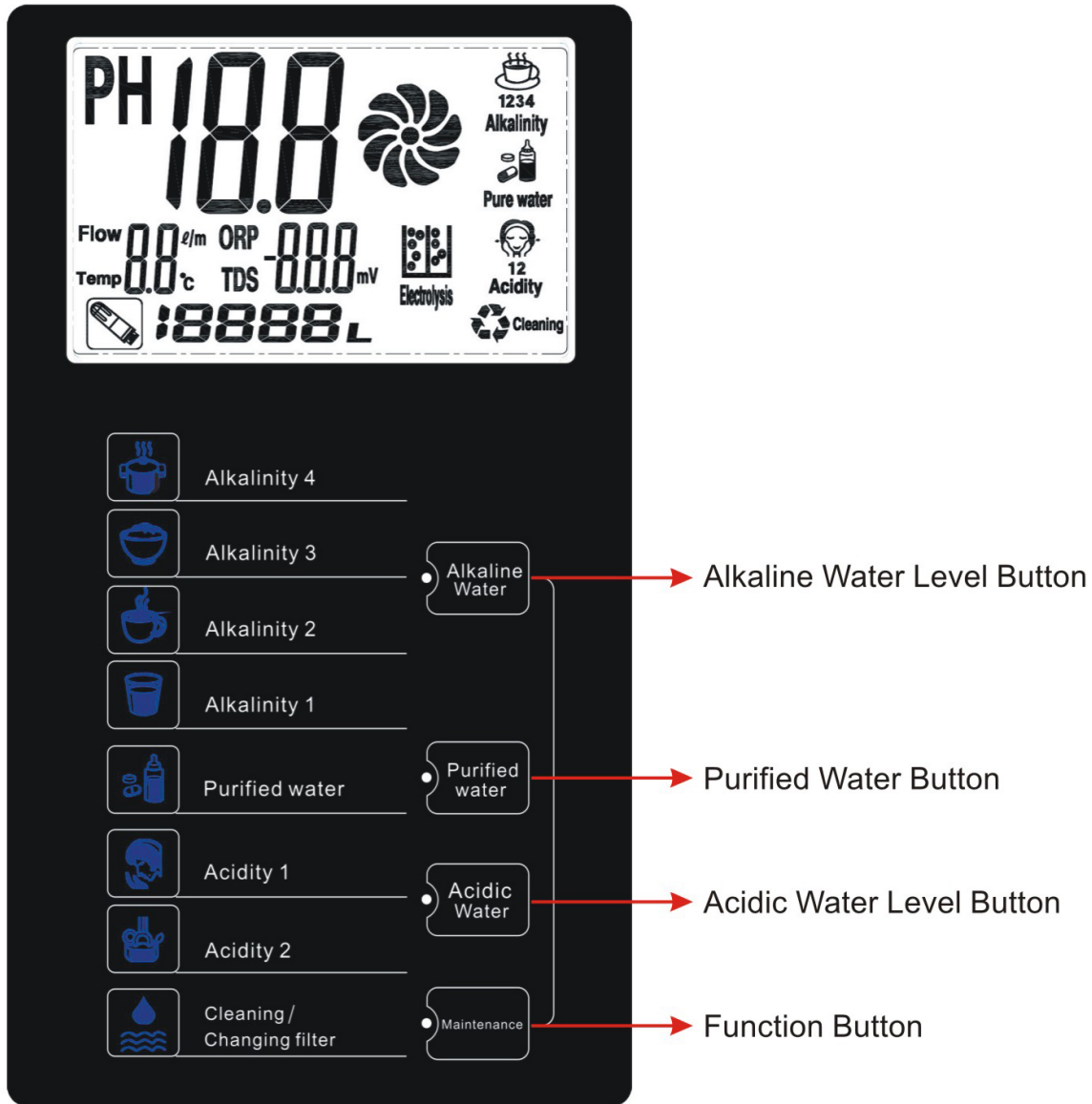

How to operate:

When the tap is turned on, water enters the ionizer. As soon as the water flow rate is over 0.8L/minute, the screen will be lit up, and the default pH level is on Alkaline Water Level 2, and at the same time, the music and a voice of "Alkaline Water Level 2" will be heard. You may press the Alkaline Water Button to select different levels of 1, 2, 3, and 4 for different pH values. You will hear "Alkaline Water Level 1", "Alkaline Water Level 3" and "Super Alkaline Water" for the different Alkaline Water Levels. When the screen light turns violet, it indicates strong alkaline condition while blue indicates normal alkaline.

When the Purified Water Button is pressed, a voice of "Filtered water " will be heard. There will be no ionizing of the water (screen light turns green). The light turns off 1 minute after water supply is turned off. The ionizer automatically switches to Alkaline Water Level 2.

When the Acidic Water Button is pressed, a different music and a voice of "Mild Acidic Water " will be heard (screen light turns yellow). Press the Acidic Water Button again, a voice of "Super Acidic Water " will be heard (screen light turns red). Light turns off 1 minute after water supply is turned off. The ionizer automatically switches to Alkaline Water Level 2.

When the Maintenance Button is pressed, the voice of "Unit Is Now Cleaning " will be heard. The screen light is red. After the cleaning, the ionizer will automatically switches to Alkaline Water Level 2.

Note: The machine will be auto-clean when the flow rate is lower than 0.8L/M (LCD is red). After 5 seconds the machine are on standby(LCD is blue). No-operation for 15 seconds, the machine will be power-down mode(LCD is out).

Panel Operation And Features

Alkaline water button

There are four sections of the alkaline water. You may choose the most suitable alkaline water, according to your needs, like cooking food, making tea, or daily drinking.

Purified Water Button

The machine will out put the neutral pH purified water for taking medicine, brewing milk etc.

Acidic water button

There are two sections of the acidic water. You may choose the acidic water for washing, cleansing or sterilizing.

Function button

When the water capacity reaches the set value, the cleaning light will be on. Press the cleaning button to start the internal cleansing during the machine is working.

When the filter life is exhausted, after replacement the filter, long press the function button, the filter life will be restored to the set value.

General Use pH instruction Tables For Water Ionizer

	Function	Uses Of Different pH Water	Same pH Foods Reference
Alkaline Water	Cooking & Food Disinfection & Dishes Cleaning	<p>pH 9.0~ 10.5 Alkaline Water Level 4 (strong alkaline)</p> <ul style="list-style-type: none"> • Good for making soups and stews. It is helpful for maintaining their nutrients and colors. • Soaking vegetables, beef, pork and fresh fish to remove fishy taste and keep the food's natural flavors. • Effectively reduces pesticides on fruits and vegetables. • Good for cleaning tough stain on dishes. • Strong antioxidant for removing the free radicals from body. 	Ginger Grapes Kelps Seaweeds
	Cooking & preparing bakeries	<p>PH 8.5~10 Alkaline Water Level 3</p> <ul style="list-style-type: none"> • Good for cooking rice, preparing noodles, bread and cake, and preserve its nature flavor longer. 	Mushrooms Soy beans Spinach
	Prepare coffee and tea	<p>pH 8.0~9.0 Alkaline Water Level 2</p> <ul style="list-style-type: none"> • Good for making tea or coffee, reduce bitterness and give better taste. • After initial period use, this level is also suitable for daily drinking and improving your overall health. • Improve conditions for upset stomach, constipation, diarrhea and gout. 	Banana Carrot Chestnut lettuce Red beans
	Initial and daily drinking	<p>PH 7.5~8.5 Alkaline Water Level 1</p> <ul style="list-style-type: none"> • For people just beginning to drink alkaline water. • Balancing internal pH, improving the assimilation of Calcium and other minerals. 	Apple Cabbage Eggplant Onion Tea
Purified Water	Purified water	<p>pH 7.0 Purified Water</p> <ul style="list-style-type: none"> • No color, no taste, no impurity • Suitable for taking medicine, preparing formula and for baby's diet. 	Asparagus Bread Milk Miso Tofu

Acidic Water	Facial & skin cleaning	PH 5.0~6.5 Acidic Water Level 1 <ul style="list-style-type: none"> • Not suitable for drinking • Close to the skin pH value, it has an astringent effect when face cleaning. • Ideal for bathing sensitive skin and infants, sunburn relief • Minimize the appearance of pores, and good for brushing teeth. • Restores shine to hair and as a nature after shave. 	Beef Beer Clam Rice Octopus
	Sterilization & disinfection & Chemicals elimination	pH 3.5~5.5 Acidic Water Level 2 <ul style="list-style-type: none"> • Not suitable for drinking • Anti-bacterial for tableware and floor cleaning. • Eliminates the residual agricultural chemicals on fruits and vegetables when soaking them in acidic water. 	Cheese Egg yolk oats squid

LCD Display Introduction

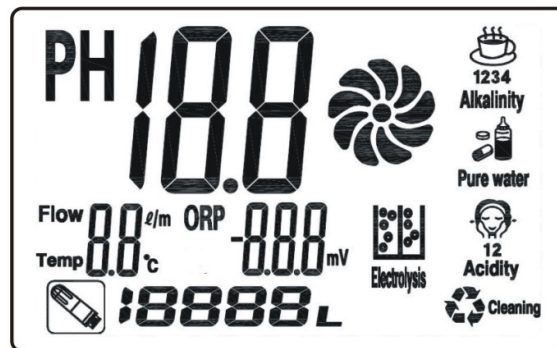

Alkaline water display: Alkaline 4 (purple) , Alkaline 3 (dark blue) , Alkaline 2 (light blue) , Alkaline 1 (white)

Pure water display: Green

Acidic water display: Acidity 2 (red) , Acidity 1 (yellow)

Flow rate: Displays the current rate of water flow through the machine

Temperature: Displays the current temperature of the water

PH: Showing output water pH value

ORP: Showing the output water oxidation reduction potential

Cleaning: The machine is cleaning

Electrolysis: The machine is electrolyzing

Impeller: The machine is working with the water passing through

Principle Of Operation

The basic principle of the water ionizer is electrolysis of water to change the PH and Oxidation-Reduction Potential (ORP) to separate the hydrogen and the hydroxide ion. In general, the water cannot decompose into O₂ and H₂ in the state of nature, but according to Faraday law of electrolysis, if adding cathode and anode into water. When the current is switched on, the water will be electrolyzed

The Anode materials are usually titanium and platinum. They are not easy to dissolve. The oxidation-reduction reaction of cathode and anode is as follows



$$E0 = 0 - 0.0591\text{pH}$$

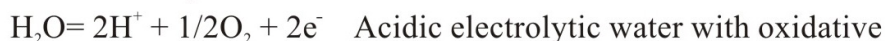

$$E0 = 1.228 - 0.0591\text{pH}$$

After the hydrogen and oxygen are produced on the surface of the cathode and anode, the water around the electrodes become alkaline and acidic. At the same time, the ORP is changed. The porous semipermeable membrane or the semipermeable membrane that Cation-anion can selectively go through the insert into the two poles to limit the water. The acidic water with high concentration and oxidative will be collected from positive pole, the alkaline water with high concentration and reductive will be collected from negative pole. This is the operation principle of water ionizer.

Function Setting

The following operations are limited to technician setting the machine only.

Do not turn on the water tap when you are going to set the machine.

1. Alkaline Water Button: pH adjusting (to make displayed pH value and actual PH close)

Pressing and holding Alkaline Water Button for about 4 seconds, buzzer sounds ding-a-dong, comes into Alkaline Water Level 1 pH adjusting and displaying "1.1" (as shown in figure), Pressing Purified Water Button(+) and Acidic Water Button(-) to do cycle adjustment from 1 to 10.

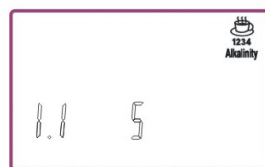

Alkaline1 Adjusting



Acidic 1 Adjusting

When you press the Alkaline Water Button the second time, comes into Alkaline Water Level 2 PH adjusting and displaying "1.2" Pressing Purified Water Button (+)

and Acidic Water Button (-) to do cycle adjustment from 3 to 12.

When you press the Alkaline Water Button the third time, comes into Alkaline Water Level 3 pH adjusting and displaying "1.3 " Pressing Purified Water Button(+)and Acidic Water Button(-) to do cycle adjustment from 8, 10, 12, 14, 16, 18, 20, 22, to 24.

When you press the Alkaline Water Button the fourth time, comes into Alkaline Water Level 4 pH adjusting and displaying "1.4" Pressing Purified Water Button(+)and Acidic Water Button(-) to do cycle adjustment from 18, 20, 22, 24, 26, 28, 30, 32, 34, 36, to 40

When you press the Alkaline Water Button the fifth time, comes into Acidic Water Level 1 PH adjusting and displaying "2.1(as shown in figure) " Pressing Purified Water Button (+)and Acidic Water Button(-) to do cycle adjustment from 10, 12, 14, 16, 18, 20, 22, 24, 26, to 28.

When you press the Alkaline Water Button the sixth time, comes into Acidic Water Level 2 PH adjusting and displaying "2.2 " Pressing Purified Water Button(+)and Acidic Water Button(-) to do cycle adjustment from 18, 20, 22, 24, 26, 28, 30, 32, 36, to 40

When you press the Alkaline Water Button the seventh time, the buzzer sounds, and the settings are saved and the ionizer will return to standby on the Alkaline Water Level 2.

Attention: The higher you set, the higher ph value you get.

2. Purified Water Button: Filter Life, Cleaning Setting, Voice Setting



Filter Life Setting

Pressing and holding Purified Water Button for about 4 seconds, the buzzer sounds ding-a-dong, comes to filter life setting, 12 items are available. They are 1000 , 2000, 3000, 4000, 5000, 6000, 7000, 8000, 9000, 10000, 11000, 12000. Use Alkaline Water Button(+) and Acidic Water Button(-) to do cycle adjustment.

Specifications of filter life setting:

The filter life begins to count down when the machine starts. Life setting range is 1000L to 12000L----each level is 1000L. When filter life reaches the set value, the filter pattern flashes prompt.

1. Under the filter life setting state, if you don't press Alkaline Water Button (+) and Acidic Water Button (-) to adjust, the old memory of filter life will not be overwritten. If you press Alkaline Water Button (+) and Acidic Water Button (-) to adjust, the current filter life settings will directly return to zero.

The input water flow rate should be over 0.8L/min, then it will drive the water flow

sensor to start the water ionizer. If less than 0.8L/min, the water ionizer can't be turned on to work. Then you may need a pump to help.

2. When the filter life is expired, press the "Maintenance" 5 seconds "directly under the standby state, the setting value returns to zero.

Press the Purified Water Button the second time, goes to cleaning setting. Press Alkaline Water Button (+) and Purified Water Button (-) to do cycle adjustment among the "30, 60, 90, EL" four numerical.

Cleaning Setting Description:

When set to 30, means when the total discharge capacity reaches 30L, cleaning light flashes. If set to "EL", when the total water discharge capacity reaches 60L, cleaning light flashes, and automatic cleaning action will go ahead next time as the water connects.



Third pressing Purified Water Button to enter the voice language settings, setting items are "ENG, CHN". Press Alkaline Water Button (+) and Purified Water Button (-) to adjust.

ENG: Voice broadcasting in English. CHN: Voice broadcasting in other language.

Third pressing Purified Water Button to enter the voice and background music settings, setting items are "S1, S2, S3". Press Alkaline Water Button (+) and Purified Water Button (-) to adjust.

S1: Play voice and background music. S2: only play voice, no background music.

S3: Turn off voice and background music.

Fourth pressing Purified Water Button to save the settings, and the ionizer will return to standby on the Alkaline Water Level 2.

3. Acidic Water Button: Settings on pH display - nominal settings have been preset in the factory, but you can adjust the electrolysis strength setting for each level as follows;

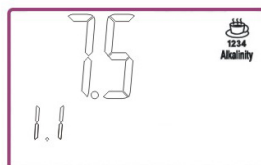

Press on the Acidic Water Button for about 4 seconds, the buzzer will give a tune to enter the pH adjustment on the Alkaline Water Level 1. It is displaying "1.1 ", as in the above picture. And press Alkaline Water Button to increase the level or the Purified Water Button to lower the electrolysis level to adjust the pH to "7.5, 8.0, 8.5, 9.0, 9.5 ", Etc.

Press the 2nd time on the Acidic Water Button to enter pH adjustment on the Alkaline Water Level 2. Repeat same procedure as above to set the strength levels for all settings.

Precautions For Use

Before using this water ionizer, please read these precautions carefully. Please operate this water ionizer following the precautions to avoid the damages to the machine or your health.

City or municipal water is recommended. Well water is not recommended.

Please replace the water filters timely, to assure the water quality is good for your health and machine's lifespan.

The input water flow rate should be over 0.8L/min, then it will drive the water flow sensor to start the water ionizer. If less than 0.8L/min, the water ionizer can't be turned on to work. Then you may need a pump to help.

Don't connect it with a water heater. Make sure the inlet water temperature is below 113 Fahrenheit degrees (45 Celsius degrees). Keep the machine away from high temperatures and direct sunlight.

Don't use water to rinse the machine directly, and don't use alcohol and other volatile solvents to wipe it, either. Please use a soft cloth with soapy water to wipe it gently.

Don't use the aluminum or copper container for the alkaline or acidity water, as the water could be contaminated by these types of containers.

Don't disassemble the machine & components. Don't block, fold or break the outlet tube. When the machine is working, for the purpose of expelling water freely, don't keep the acidity water outlet tube in a high place. And the acidity water tube should be no more than 60cm in length.

Every morning before collecting alkaline water from the ionizer, allow the water to run for 10~30 seconds to flush out the water in the machine and filters. And the end of the day, it is suggested to flush for 10-15 seconds in the "Purified water" level and "Acidic Water" level to prevent scaling.

The ionized alkaline & acidic water should be used as soon as possible within 24 hours.

Don't take medicine with alkaline water, Use purified water.

Don't drink acidic water.

Please disconnect the power plug when not using the machine for long period.

Troubleshooting

Issue 1:The power supply light is not on or LCD screen does not display.

Solution: Please check if electricity is connected properly and re-plug in the cord.

Issue 2: The machine keeps beeping (alarming).

(Note the symbols on the LCD display while the machine beeping)

Solution: If there is a "H1" displayed on the LCD, it means the tap water temperature is too high, please turn off the tap water and do not let HOT water enter the machine.

Issue 3: Touch control panel does not function or respond (but the machine can still work normally).

Solution: Please unplug the power cord and wait a minute, then plug in the power cord. After the power is re-applied, the unit should return to normal operation. Note: do not locate the ionizer near electromagnetic radiation appliances, ie microwave ovens.

Issue 4: Background light on LCD is not on and the LCD is dark.

Solution: the tap water pressure is LOW, please increase the water pressure and check if the filter blocked or not. Replace filters as needed.

Issue 5: Acidic /alkaline water or purified water does come out.

Solution: Please replace the water filters if needed. If water pressure is too LOW, please increase it. If "cleaning indicator" light is "ON", please initiate cleaning cycle.

Issue 6: There is some white sediment in the alkaline water.

Solution: The alkaline water after the production is usually whitish color, this is normal and the water is OK to drink.

Issue 7: A white film appears on the inner wall of the alkaline water container.

Solution: This is a crystallization of calcium carbonate by gas in the air after the reaction of solid components of calcium. These white substances are normal when generating alkaline water. It does not imply there is anything wrong with the water. The water is OK to drink.

Note: If this condition persists, please use food grade citric acid to clean the plates or white vinegar. Allow the machine to soak for a few hours and flush thoroughly. Please see maintenance procedures.

Note: If the machine will not be used for a long period, please unplug the power cord, remove the filter and remove the Water Converter and water purifier. Drain thoroughly and place the filter in a sealed plastic bag and store in the refrigerator.

Issue 8: Alkaline water output amount reduces gradually.

Possible causes and solutions:

Inlet Water Pressure- make sure input water pressure is sufficient -above 40 psi.

Filter blockage - please make sure filter life is OK and replace filters as needed.

Excessive build up of calcium deposits in the outlet tube - please clean the outlet tube as needed. Soak in vinegar as needed.

Excessive build up of calcium deposits on the electrolysis plates - please contact customer service for support.

Daily Drinking



Cooking Foods



Disinfection & Sterilization



Making Coffee & Tea



Face & Body Cleaning



Children Drinking



Milk Powder & Medicine

