

M110 Manual Filling Machine

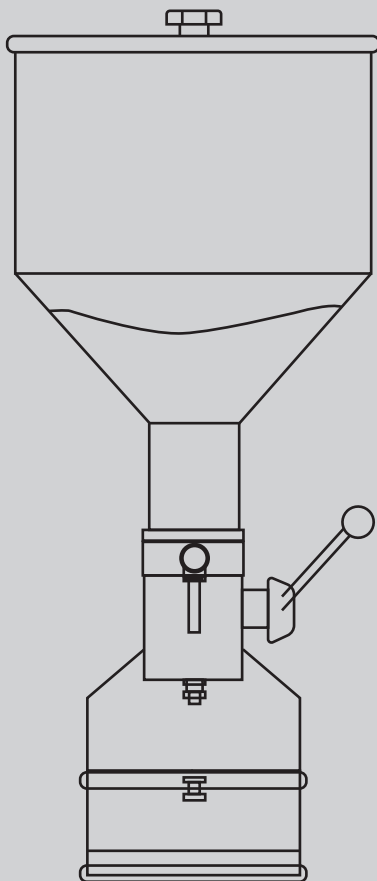

FILLING MACHINE

Model: M110

EN

User Manual

PLEASE READ THE MANUAL CAREFULLY BEFORE OPERATION

**WARNING!**

Read the following instructions before using the product!

These instructions below are for your safety. Please read through them thoroughly before use and retain them for future reference. Familiarize yourself with them to reduce hazards like personal injuries and damage to property.

TABLE OF CONTENTS

Introdctions	02
Note Before Use	02
Internal Structure	03
Technical parameters	03
How To Use	04
Common problems & Solutions	05
Our services	06

THE MAIN PRODUCTS FOR US

Filling machine

Packing machine

And other mechanical equipment

Sealing machine

Coding machine

We also customize all kinds of packaging machinery according to customer needs.

INTRODCTIONS

M110 maual filling machine is specially designed for small and medium enterpris-es.

The machine has simple and reasonable structure, convenient manual operation, without any energy.

- Can only be used for liquid paste with good liquidity.
- It is suitable for medicine, daily chemical, food, pesticide and other industries.
- Can fill beverage, fluid food, lubricating oil, shampoo and other liquid paste material(Without Particulate).
- All parts in contact with the filling object are made of 304 stainless steel and Polytetrafluoroethylene.
- The maximum capacity of the hopper is 10 kg, Filling capacity can be set freely.
- The machine is extremely accurate (+/- 1%) and simple to operate.

Name	Parameters
Filling Range	20 - 110 (ml)
Hopper Capacity	10 (kg)
Accuracy	±1%
Filling Material	Cream, Shampoo, Cosmetic etc.
Machine Size	710 x 280 x 230 mm
Machine Weight	≈ 10 kg / 22 lb

NOTE BEFORE USE

1. In order to protect the piston of the machine, we will grease the piston before the machine leaves the factory

2. We recommend cleaning these lubricants with a deoiling agent before use the machine

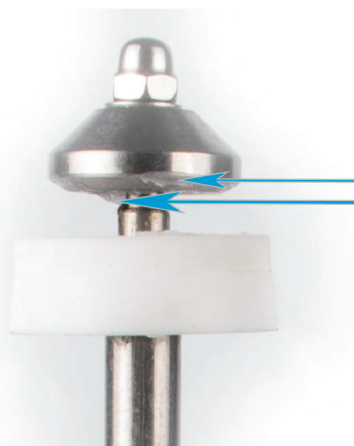

INTERNAL STRUCTURE

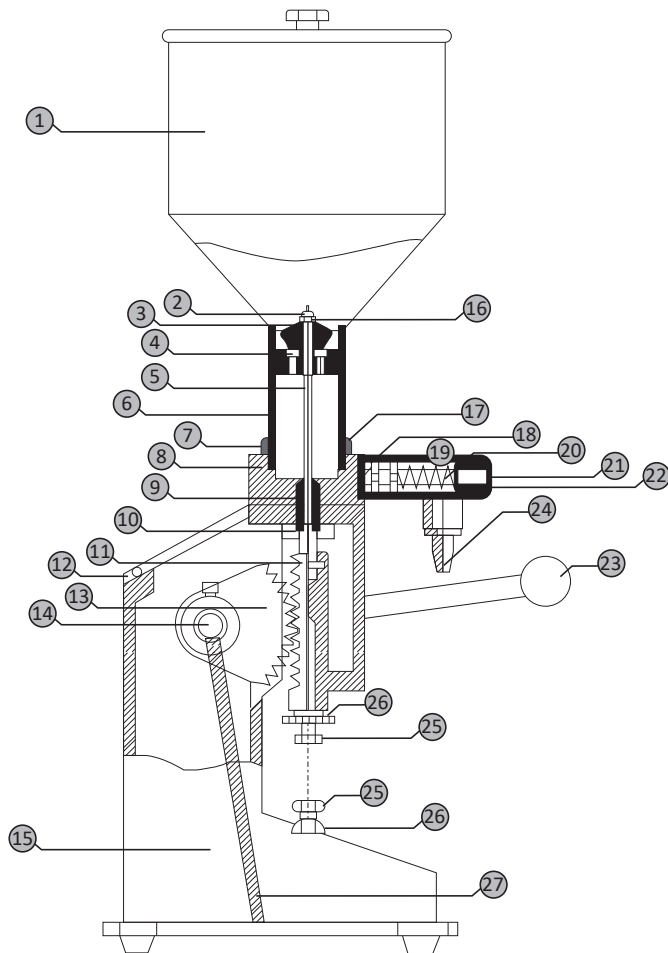

- | | | | | | | | | | |
|----|--------------|----|-------------------|----|--------------|----|---------------|----|-----------------|
| 1 | Hopper | 2 | Screw Cap | 3 | Cone Cover | 4 | Piston Ring | 5 | Piston Rod |
| 6 | Measure Jar | 7 | Fastener | 8 | Jar Base | 9 | Seal Ring | 10 | Seal Receptacle |
| 11 | Rack | 12 | Upper Cover Plate | 13 | Sector Gear | 14 | Abscissa Axis | | |
| 15 | Machine Body | 16 | | 17 | | 18 | O Ring | 19 | Valve Core |
| | | 20 | Spring | 21 | Outlet Screw | 22 | O Ring | 23 | Handle |
| | | 24 | Nozzle | 25 | Locking Nut | 26 | Measure Nut | 27 | Spring |

HOW TO USE

1. CLEAN THE MACHINE BEFORE USE

We recommend that you clean the machine before using it.



1 Remove The Screw

Remove The Screw

2 Unloading Hopper

Unloading Hopper

3 Clean the Machine

Clean the Machine

Hold the base in place, and turn the hopper counterclockwise
Clean the parts of the hopper and discharge nozzle that touch the filling

2. SET THE DISCHARGE QUANTITY

- 1.loosen the adjusting cap (26).
- 2.rotate the adjusting screw (25) to adjust the discharge quantity.
- 3.After adjusting to the required capacity. Tighten the adjusting cap (26)

3. USE THE MACHINE

Add the filling material to the hopper and press the discharge through the manual handle

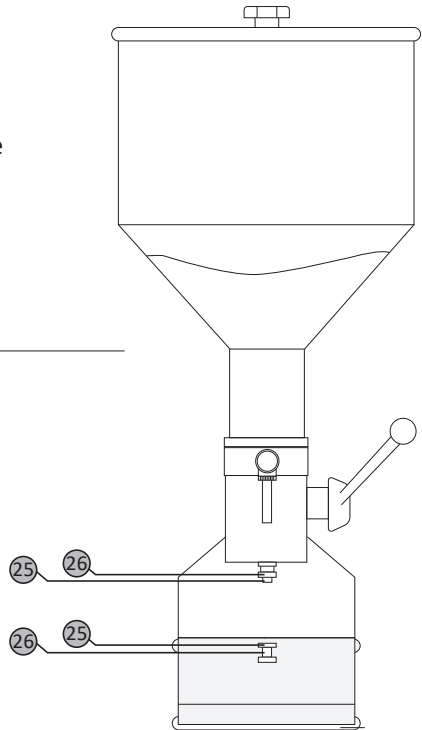

COMMON PROBLEMS & SOLUTIONS

(Internal Structure)

1, THE DISCHARGE NOZZLE IS LEAKING

- If you fill the hopper with water and the machine leaks
You need to check the seal ring
Is due to the loose seal as shown in the picture below ①.
Please clean or replace this O ring

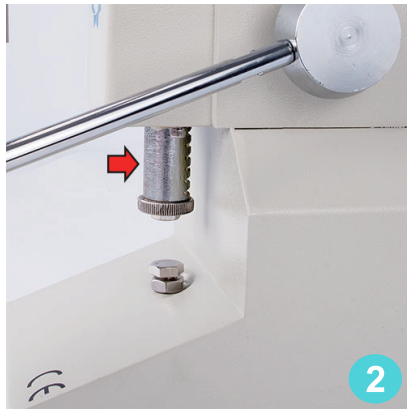

- The o-ring of the valve core is damaged
Replace the o-ring (16.17.18)
- There are sundries sticking to the o-ring(16.17.18),
which causes excessive suction of the material and damages the surface
tension of the nozzle.
Unpick and wash

2, THE MACHINE IS NOISY IN USE. OR THE HANDLE IS HARD TO PRESS.

If the machine works, it creaks. Or the handle is hard to press
Please add the lubricating oil as shown in the picture above ②

3, AFTER FILLING, THE MATERIAL IS MIXED WITH AIR BUBBLES

- Too fast filling speed
Reduce filling speed
- Failure of sealing ring inside sealing seat (9)
Replace

4, THE DISCHARGE QUANTITY IS NOT ACCURATE

- Debris between cone cover (3) and piston (4) sticks to the sealing ring,
Causing material backflow and affecting accuracy
Open and clean
 - Piston ring (4) overwears, loses tension and friction
Replace piston rings
 - Paste product viscosity is too large, poor liquidity
Slow down the lifting motion of the handle (23)
Cap is loose (26)
Screw up
-

5, IF THE MACHINE PARTS ARE MISSING OR DAMAGED, PLEASE CONTACT US TO REPLACE THEM

- We will supply you with new spare parts or replacement.
You can contact the seller through the order screen
-

ABOUT OUR SERVICES

- Different from other sellers, as a company integrating R&D and production, we can provide a complete and comprehensive backup catalogue of spare parts, so that if you need any spare parts, whether within or outside the warranty period, we can assist you
- After you receive the machine and during the usage of the machine , no matter what problem you meet you can contact us through the order page(Contact Seller), and we will support you within 12 hours
We offer one year guarantee, that means, within one year, no matter what kind of problem happened to the machine, contact us and we will solve the problem.
even if over one year, we can also help to provide spare parts and technical supports.
THIS IS OUR PROMISE TO ALL OUR CUSTOMERS
- You can contact us instead of Free Amazon tech support included
Because We are a technology company, more professional, can provide more help and support
Our customer service email,
sumeve-customer service@outlook.com



Please feel free to contact us
if there is any missing or damage in the packing list

we are a company specialized in producing and
developing packaging machinery and equipment.